



NEXUS BOOK

2019

TABLE OF CONTENTS

2019 Viper 25V		2
2019 Viper 27V		3
2019 Viper 29V		4
2019 Phantom 25P		5
2019 Phantom 31P		6
2019 Phantom 32P		7
2019 Ghost 33DS		8
2019 Ghost 34DS		9
2019 Ghost 36DS		10
2019 Wraith 32W		11
2019 Wraith 33W		12
2019 Wraith 34W		13
2019 Wraith 35W		14
2019 Maybach 32M		15
2019 Maybach 37M		16
2019 Bentley 34B		17
2019 Bentley 38B		18
2019 Evoque 37E		19
Jack Drawings	(7214, 7636, 7842A)	20-28
Pump Drawings	(7948KS, 70127KS)	29-40
Hose Kits	(70114, 70123, 70129, 70139)	41-48
Wiring Schematic	(8433/8726, 8438, 8439)	49-51

**MY2019 NEXUS
VIPER 25V**

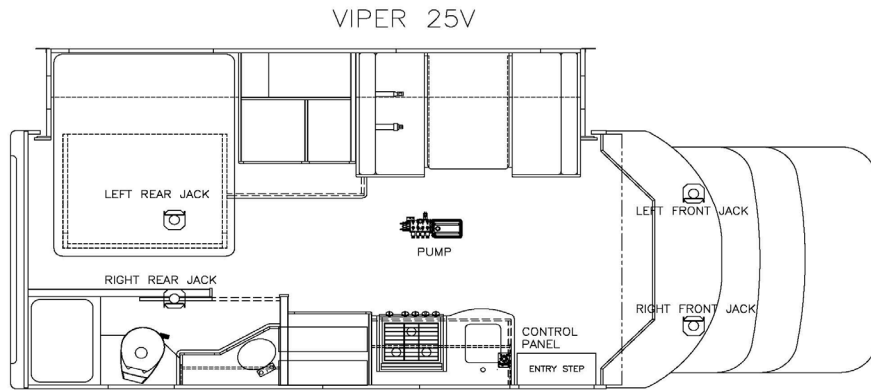

Notes:

[illegible]

VIPER 27V



Options

2019 NEXUS PARTS CHART 6-14-18.xls 7/9/2018

VIPER 29V



Revisions

**MY2019 NEXUS
PHANTOM 25P**

PHANTOM 25P

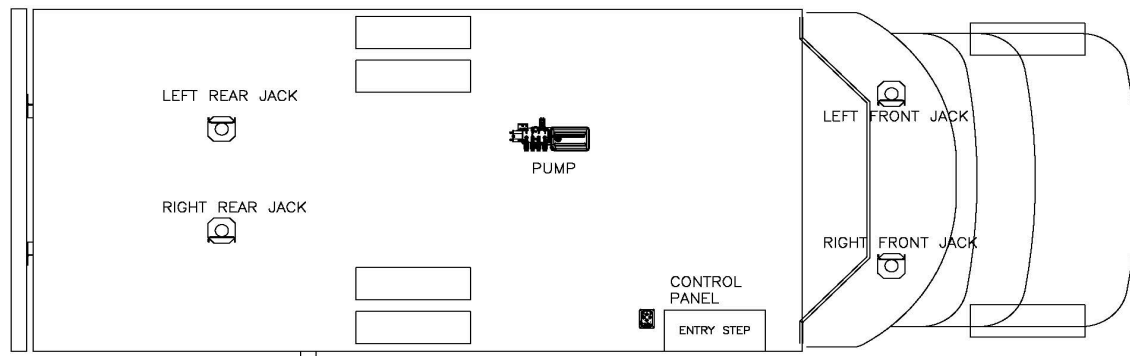

Notes:

Item, Length	Description / Location	Qty	Color	Equalizer Part No.
Kit	(Items listed below)	1		8433
Pump	4-Function, Jacks	1		7948KS
Jack	7,500 lbs, 13" Stroke	4		7842A
Control Panel	Located near entry door	1		3197SBT
Harness	Connects Control Panel & Pump	1		6133-10
Hose Kit	Complete Set of Hoses	1		70123
Hose, 6'	LR Jack Bottom to RR Jack Bottom	1	Orange/Yellow Stripe	2461
Hose, 8'	LF Jack Bottom to RF Jack Bottom	1	Brown/White Stripe	2463
Hose, 14'	Pump to Jack, Left Rear Top	1	Orange Solid	2469
Hose, 12'	Pump to Jack, Left Front Top	1	Brown Solid	2467
Hose, 12'	Pump to Jack, Left Front Bottom	1	Brown Stripe	2467
Hose, 16'	Pump to Jack, Left Rear Bottom	1	Orange Stripe	2471
Hose, 18'	Pump to Jack, Right Rear Top	1	Yellow Solid	2473
Hose, 14'	Pump to Jack, Right Front Top	1	White Solid	2469

Options

Revisions

**MY2019 NEXUS
PHANTOM 31P**

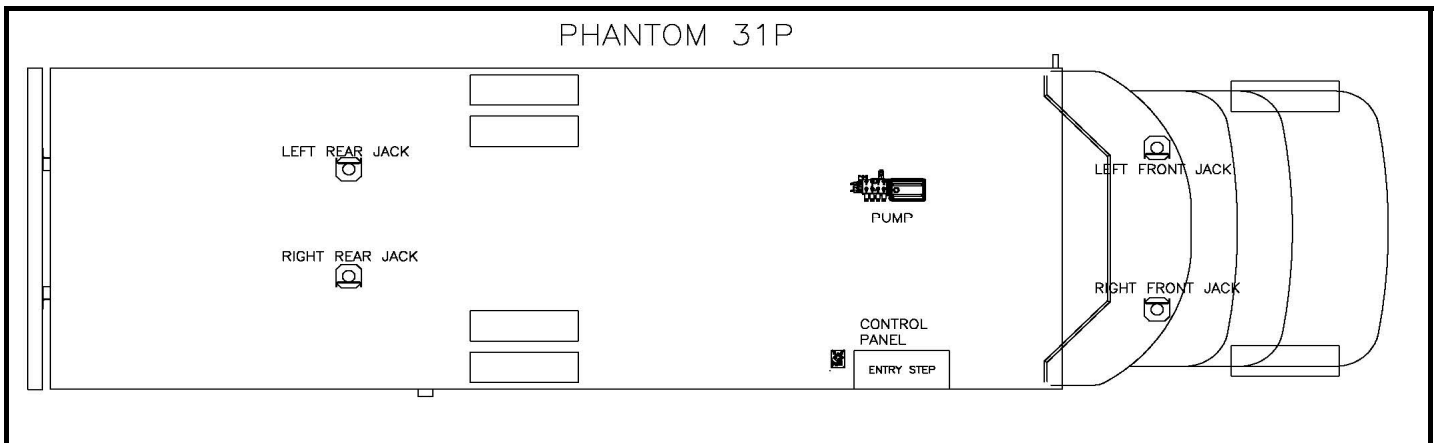

Notes:

Item, Length	Description / Location	Qty	Color	Equalizer Part No.
Kit	(Items listed below)	1		8433
Pump	4-Function, Jacks	1		7948KS
Jack	7,500 lbs, 13" Stroke	4		7842A
Control Panel	Located near entry door	1		3197SBT
Harness	Connects Control Panel & Pump	1		6133-10
Hose Kit	Complete Set of Hoses	1		70123
Hose, 6'	LR Jack Bottom to RR Jack Bottom	1	Orange/Yellow Stripe	2461
Hose, 8'	LF Jack Bottom to RF Jack Bottom	1	Brown/White Stripe	2463
Hose, 12'	Pump to Jack, Left Front Top	1	Brown Solid	2467
Hose, 12'	Pump to Jack, Left Front Bottom	1	Brown Stripe	2467
Hose, 14'	Pump to Jack, Left Rear Top	1	Orange Solid	2469
Hose, 14'	Pump to Jack, Right Front Top	1	White Solid	2469
Hose, 16'	Pump to Jack, Left Rear Bottom	1	Orange Stripe	2471
Hose, 18'	Pump to Jack, Right Rear Top	1	Yellow Solid	2473

Options				

Revisions				

PHANTOM 32P



Revisions

**MY2019 NEXUS
GHOST 33DS (DURASTAR)**

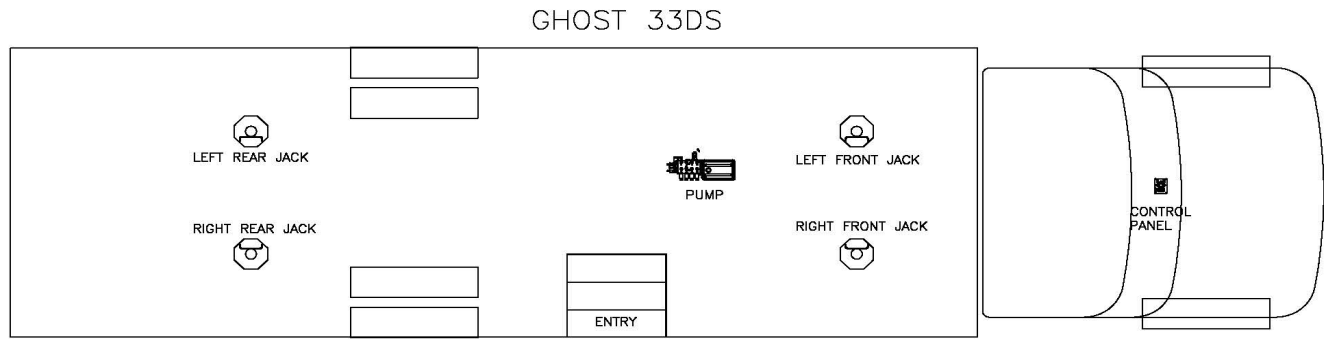

Notes:

[illegible]

**MY2019 NEXUS
GHOST 34DS (DURASTAR)**

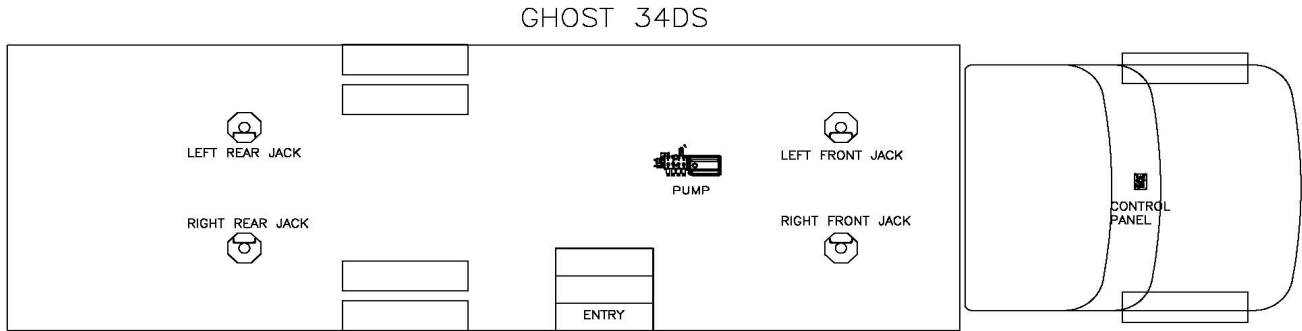

Notes:

[illegible]

**MY2019 NEXUS
GHOST 36DS (DURASTAR)**

GHOST 36DS

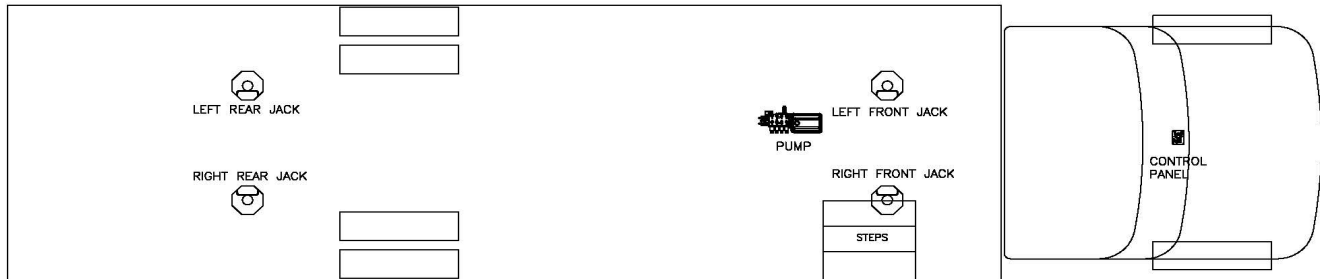

Notes:

Item, Length	Description / Location	Qty	Color	Equalizer Part No.
Kit	(Items listed below)	1		8439
Pump	4-Function, Jacks	1		70127KS
Jack	12,000 lbs, 16" Stroke	4		7214
Control Panel	Located in center of dash	1		3197SBT
Harness	Connects Control Panel & Pump	1		6133-20
Hose Kit	Complete Set of Hoses	1		70129
Hose, 6'	Pump to Jack, Left Front Top	1	Brown Solid	2461
Hose, 8'	Pump to Jack, Left Front Bottom	1	Brown Stripe	2463
Hose, 10'	Pump to Jack, Right Front Top	1	White Solid	2465
Hose, 12'	Pump to Jack, Right Front Bottom	1	White Stripe	2467
Hose, 8'	LR Jack Bottom to RR Jack Bottom	1	Orange/Yellow Stripe	2463
Hose, 18'	Pump to Jack, Left Rear Top	1	Orange Solid	2473
Hose, 20'	Pump to Jack, Left Rear Bottom	1	Orange Stripe	2475
Hose, 22'	Pump to Jack, Right Rear Top	1	Yellow Solid	2476

Options

Revisions

WRAITH 32W

2019 NEXUS PARTS CHART 6-14-18.xls 7/9/2018

WRAITH 33W

2019 NEXUS PARTS CHART 6-14-18.xls 7/9/2018

**MY2019 NEXUS
WRAITH 34W**

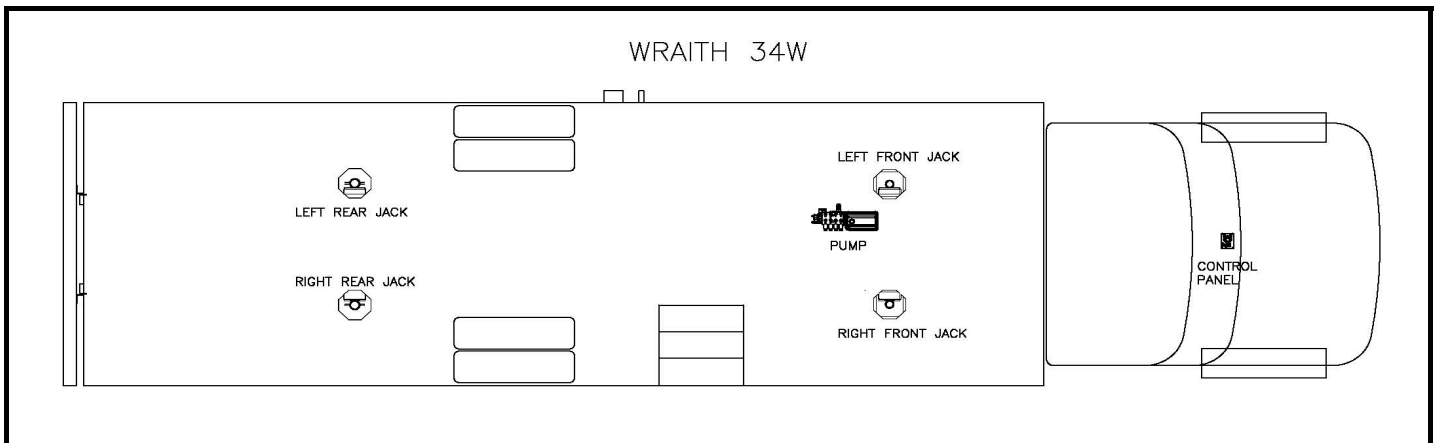

Notes:

Item, Length	Description / Location	Qty	Color	Equalizer Part No.
Kit	(Items listed below)	1		8439
Pump	4-Function, Jacks	1		70127KS
Jack	12,000 lbs, 16" Stroke	4		7214
Control Panel	Located in center of dash	1		3197SBT
Harness	Connects Control Panel & Pump	1		6133-20
Hose Kit	Complete Set of Hoses	1		70129
Hose, 6'	Pump to Jack, Left Front Top	1	Brown Solid	2461
Hose, 8'	Pump to Jack, Left Front Bottom	1	Brown Stripe	2463
Hose, 10'	Pump to Jack, Right Front Top	1	White Solid	2465
Hose, 12'	Pump to Jack, Right Front Bottom	1	White Stripe	2467
Hose, 8'	LR Jack Bottom to RR Jack Bottom	1	Orange/Yellow Stripe	2463
Hose, 18'	Pump to Jack, Left Rear Top	1	Orange Solid	2473
Hose, 20'	Pump to Jack, Left Rear Bottom	1	Orange Stripe	2475
Hose, 22'	Pump to Jack, Right Rear Top	1	Yellow Solid	2476

Options				

Revisions				

**MY2019 NEXUS
WRAITH 35W**

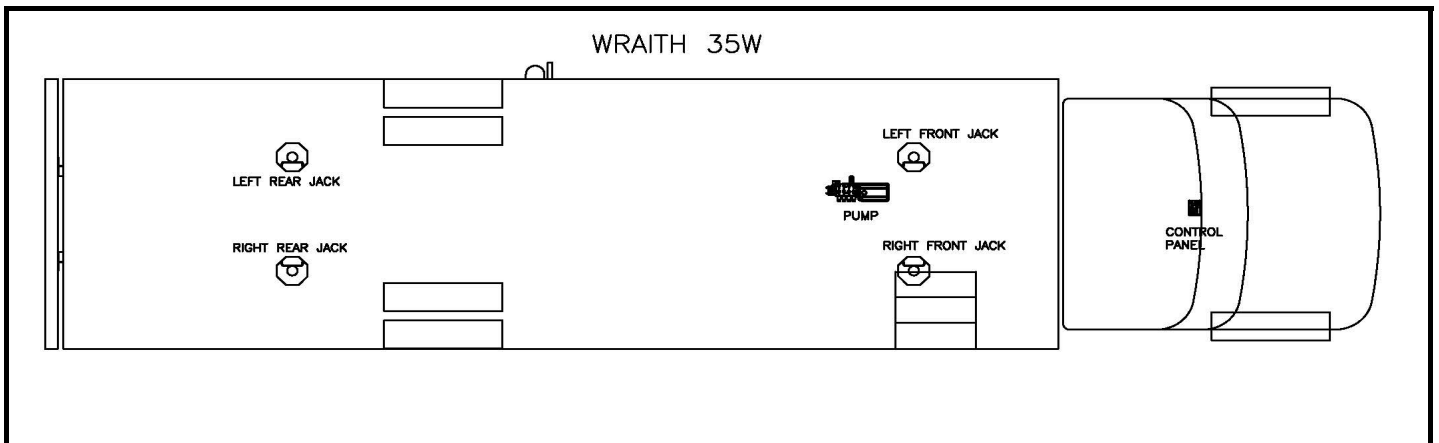

Notes:

Item, Length	Description / Location	Qty	Color	Equalizer Part No.
Kit	(Items listed below)	1		8439
Pump	4-Function, Jacks	1		70127KS
Jack	12,000 lbs, 16" Stroke	4		7214
Control Panel	Located in center of dash	1		3197SBT
Harness	Connects Control Panel & Pump	1		6133-20
Hose Kit	Complete Set of Hoses	1		70129
Hose, 6'	Pump to Jack, Left Front Top	1	Brown Solid	2461
Hose, 8'	Pump to Jack, Left Front Bottom	1	Brown Stripe	2463
Hose, 10'	Pump to Jack, Right Front Top	1	White Solid	2465
Hose, 12'	Pump to Jack, Right Front Bottom	1	White Stripe	2467
Hose, 8'	LR Jack Bottom to RR Jack Bottom	1	Orange/Yellow Stripe	2463
Hose, 18'	Pump to Jack, Left Rear Top	1	Orange Solid	2473
Hose, 20'	Pump to Jack, Left Rear Bottom	1	Orange Stripe	2475
Hose, 22'	Pump to Jack, Right Rear Top	1	Yellow Solid	2476

Options				

Revisions				

**MY2019 NEXUS
MAYBACH 32M**

MAYBACH 32M

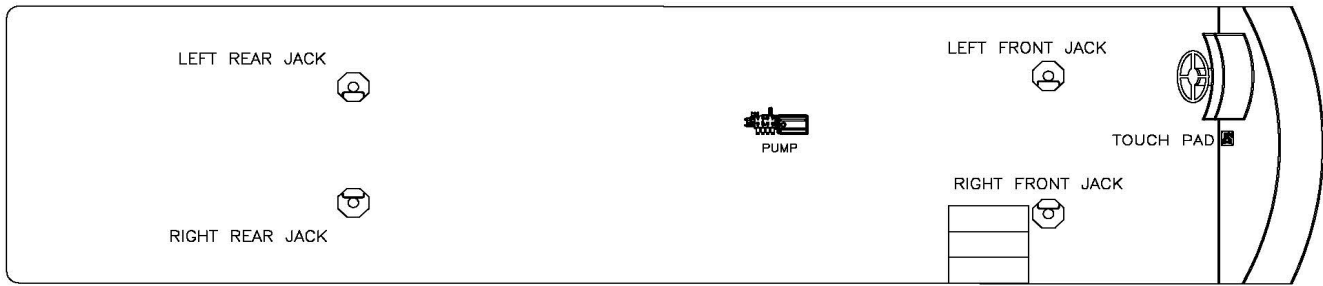

Notes:

Item, Length	Description / Location	Qty	Color	Equalizer Part No.
Kit	(Items listed below)	1		8438
Pump	4-Function, Jacks	1		7948KS
Jack	7,500 lbs, 16" Stroke(Front Jacks)	2		7636
Jack	12,000 lbs, 16" Stroke(Rear Jacks)	2		7214
Control Panel	Located in dash to right of driver seat	1		3197SBT
Harness	Connects Control Panel & Pump	1		6133-20
Hose Kit	Complete Set of Hoses	1		70114
Hose, 10'	Pump to Jack, Left Front Top	1	Brown Solid	2465
Hose, 12'	Pump to Jack, Left Front Bottom	1	Brown Stripe	2467
Hose, 14'	Pump to Jack, Right Front Top	1	White Solid	2469
Hose, 10'	LF Jack Bottom to RF Jack Bottom	1	Brown/White Stripe	2465
Hose, 10'	LR Jack Bottom to RR Jack Bottom	1	Orange/Yellow Stripe	2465
Hose, 18'	Pump to Jack, Left Rear Top	1	Orange Solid	2473
Hose, 20'	Pump to Jack, Left Rear Bottom	1	Orange Stripe	2475
Hose, 20'	Pump to Jack, Right Rear Top	1	Yellow Solid	2475

Options

Revisions

**MY2019 NEXUS
MAYBACH 37M**

MAYBACH 37M

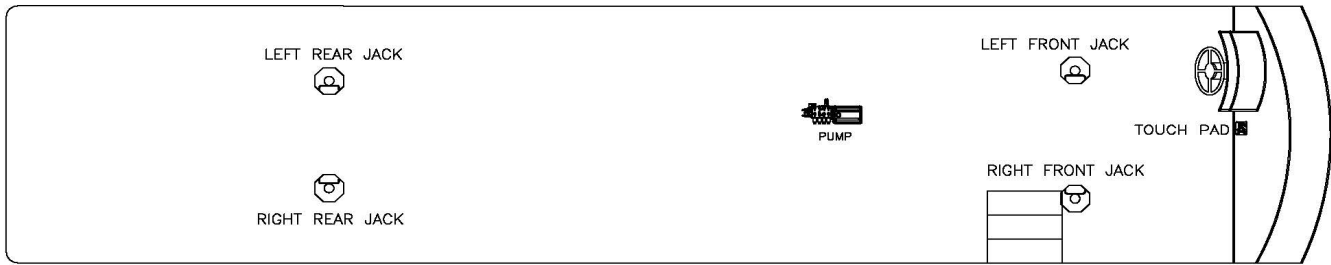

Notes:

Item, Length	Description / Location	Qty	Color	Equalizer Part No.
Kit	(Items listed below)	1		8438
Pump	4-Function, Jacks	1		7948KS
Jack	7,500 lbs, 16" Stroke(Front Jacks)	2		7636
Jack	12,000 lbs, 16" Stroke(Rear Jacks)	2		7214
Control Panel	Located in dash to right of driver seat	1		3197SBT
Harness	Connects Control Panel & Pump	1		6133-20
Hose Kit	Complete Set of Hoses	1		70114
Hose, 10'	Pump to Jack, Left Front Top	1	Brown Solid	2465
Hose, 12'	Pump to Jack, Left Front Bottom	1	Brown Stripe	2467
Hose, 14'	Pump to Jack, Right Front Top	1	White Solid	2469
Hose, 10'	LF Jack Bottom to RF Jack Bottom	1	Brown/White Stripe	2465
Hose, 10'	LR Jack Bottom to RR Jack Bottom	1	Orange/Yellow Stripe	2465
Hose, 18'	Pump to Jack, Left Rear Top	1	Orange Solid	2473
Hose, 20'	Pump to Jack, Left Rear Bottom	1	Orange Stripe	2475
Hose, 20'	Pump to Jack, Right Rear Top	1	Yellow Solid	2475

Options

Revisions

**MY2019 NEXUS
BENTLEY 34B**

BENTLEY 34B

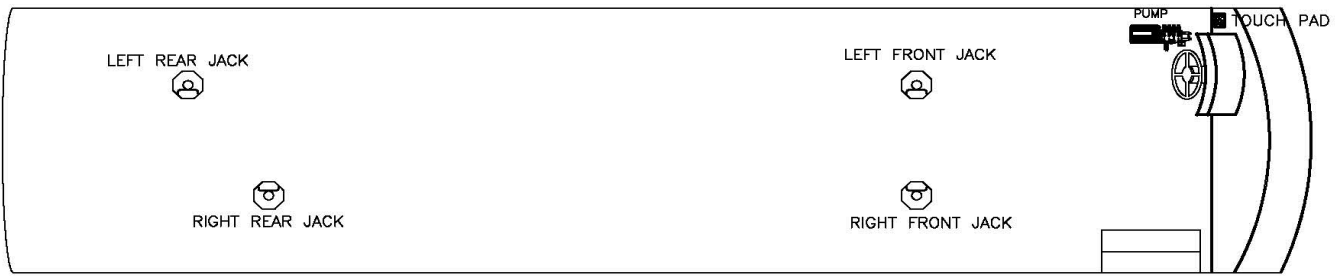

Notes:

Item, Length	Description / Location	Qty	Color	Equalizer Part No.
Kit	(Items listed below)	1		8726
Pump	4-Function, Jacks	1		7948KS
Jack	12,000 lbs, 16" Stroke(Rear Jacks)	4		7214
Control Panel	Located in dash to right of driver seat	1		3197SBT
Harness	Connects Control Panel & Pump	1		6133-10
Hose Kit	Complete Set of Hoses	1		70139
Hose, 14'	Pump to Jack, Left Front Top	1	Brown Solid	2469
Hose, 14'	Pump to Jack, Left Front Bottom	1	Brown Stripe	2469
Hose, 18'	Pump to Jack, Right Front Top	1	White Solid	2473
Hose, 8'	LF Jack Bottom to RF Jack Bottom	1	Brown/White Stripe	2463
Hose, 10'	LR Jack Bottom to RR Jack Bottom	1	Orange/Yellow Stripe	2465
Hose, 38'	Pump to Jack, Left Rear Top	1	Orange Solid	2488
Hose, 38'	Pump to Jack, Left Rear Bottom	1	Orange Stripe	2488
Hose, 40'	Pump to Jack, Right Rear Top	1	Yellow Solid	2490

Options

Revisions

**MY2019 NEXUS
BENTLEY 38B**

BENTLEY 38B

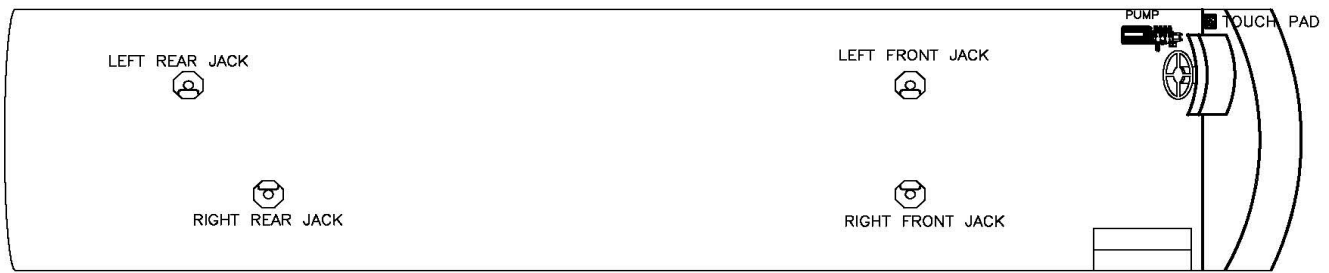

Notes:

Item, Length	Description / Location	Qty	Color	Equalizer Part No.
Kit	(Items listed below)	1		8726
Pump	4-Function, Jacks	1		7948KS
Jack	12,000 lbs, 16" Stroke(Rear Jacks)	4		7214
Control Panel	Located in dash to right of driver seat	1		3197SBT
Harness	Connects Control Panel & Pump	1		6133-10
Hose Kit	Complete Set of Hoses	1		70139
Hose, 14'	Pump to Jack, Left Front Top	1	Brown Solid	2469
Hose, 14'	Pump to Jack, Left Front Bottom	1	Brown Stripe	2469
Hose, 18'	Pump to Jack, Right Front Top	1	White Solid	2473
Hose, 8'	LF Jack Bottom to RF Jack Bottom	1	Brown/White Stripe	2463
Hose, 10'	LR Jack Bottom to RR Jack Bottom	1	Orange/Yellow Stripe	2465
Hose, 38'	Pump to Jack, Left Rear Top	1	Orange Solid	2488
Hose, 38'	Pump to Jack, Left Rear Bottom	1	Orange Stripe	2488
Hose, 40'	Pump to Jack, Right Rear Top	1	Yellow Solid	2490

Options

Revisions

**MY2019 NEXUS
EVOQUE 37E**

EVOQUE 37E

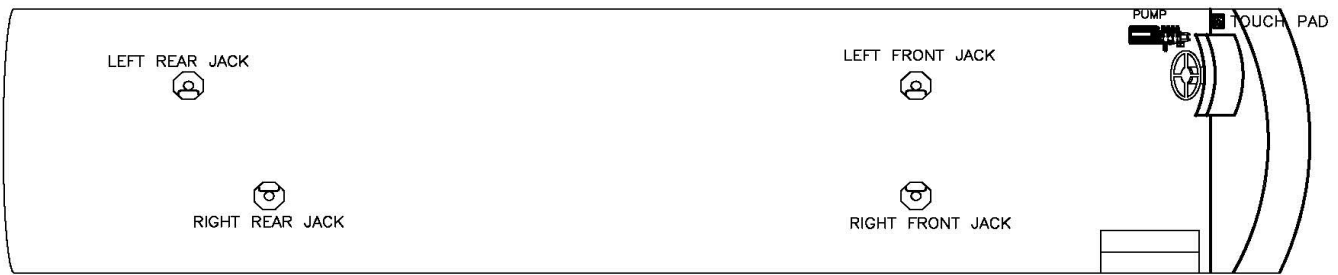

Notes:

Item, Length	Description / Location	Qty	Color	Equalizer Part No.
Kit	(Items listed below)	1		8726
Pump	4-Function, Jacks	1		7948KS
Jack	12,000 lbs, 16" Stroke(Rear Jacks)	4		7214
Control Panel	Located in dash to right of driver seat	1		3197SBT
Harness	Connects Control Panel & Pump	1		6133-10
Hose Kit	Complete Set of Hoses	1		70139
Hose, 14'	Pump to Jack, Left Front Top	1	Brown Solid	2469
Hose, 14'	Pump to Jack, Left Front Bottom	1	Brown Stripe	2469
Hose, 18'	Pump to Jack, Right Front Top	1	White Solid	2473
Hose, 8'	LF Jack Bottom to RF Jack Bottom	1	Brown/White Stripe	2463
Hose, 10'	LR Jack Bottom to RR Jack Bottom	1	Orange/Yellow Stripe	2465
Hose, 38'	Pump to Jack, Left Rear Top	1	Orange Solid	2488
Hose, 38'	Pump to Jack, Left Rear Bottom	1	Orange Stripe	2488
Hose, 40'	Pump to Jack, Right Rear Top	1	Yellow Solid	2490

Options

Revisions

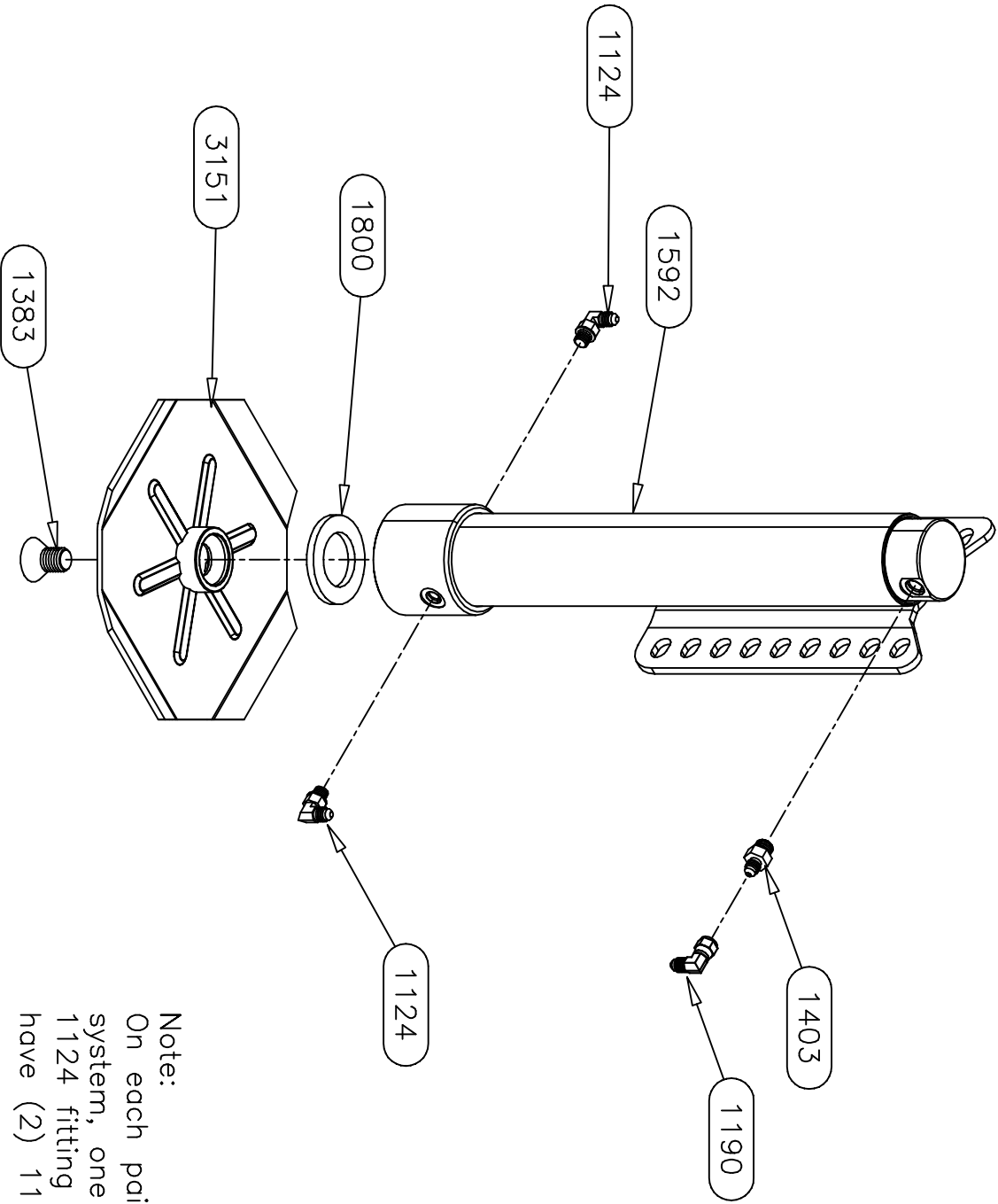

Note:
On each pair of jacks in this system, one jack will have (1) 1124 fitting and the other will have (2) 1124 fittings.

<div>Equalizer</div>										55169 COUNTRY ROAD 3 ELKHART, IN 46515																			
#										REVISIONS																			
										BY:																			
										DATE:																			
UNLESS OTHERWISE SPECIFIED: TOLERANCES: .XXX ± 0.010 .XX ± 0.010 .X ± 0.030 ANG. ± 1/2" REMOVE ALL BURRS AND SHARP EDGES .015 MAX										TITLE										USED ON:									
										MH 16 SL LEG ASSEMBLY										NEXUS									
										SIZE SCALE MATERIAL										NOTED									
										A 1:1 A S										PART NAME:									
										DRW BY: SU										SL 16 S-NEXUS									
APPD BY: —										DATE:										PAGE: 2 OF 3									
																				DWG NO.: P7214									
																				REV: —									

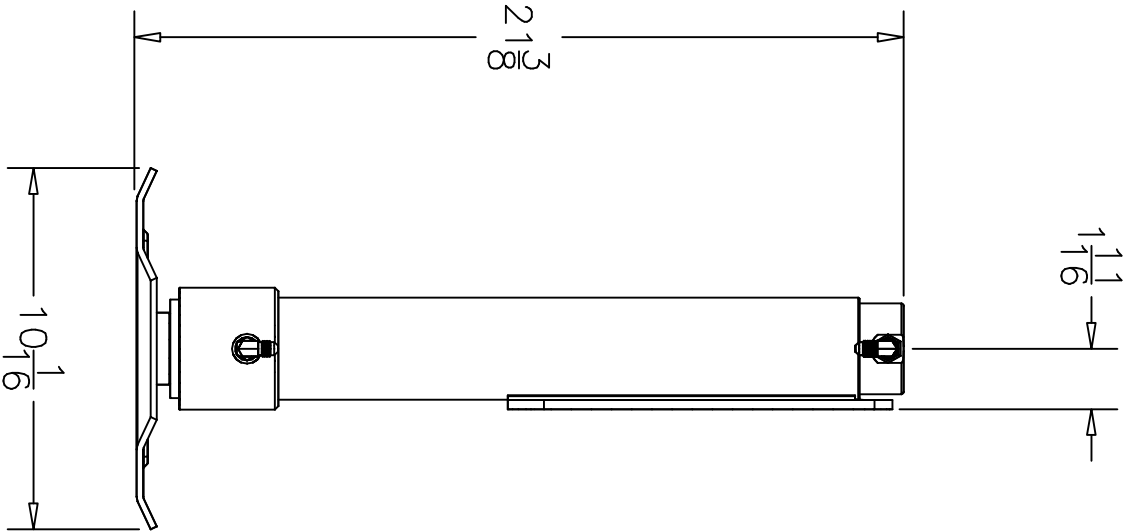
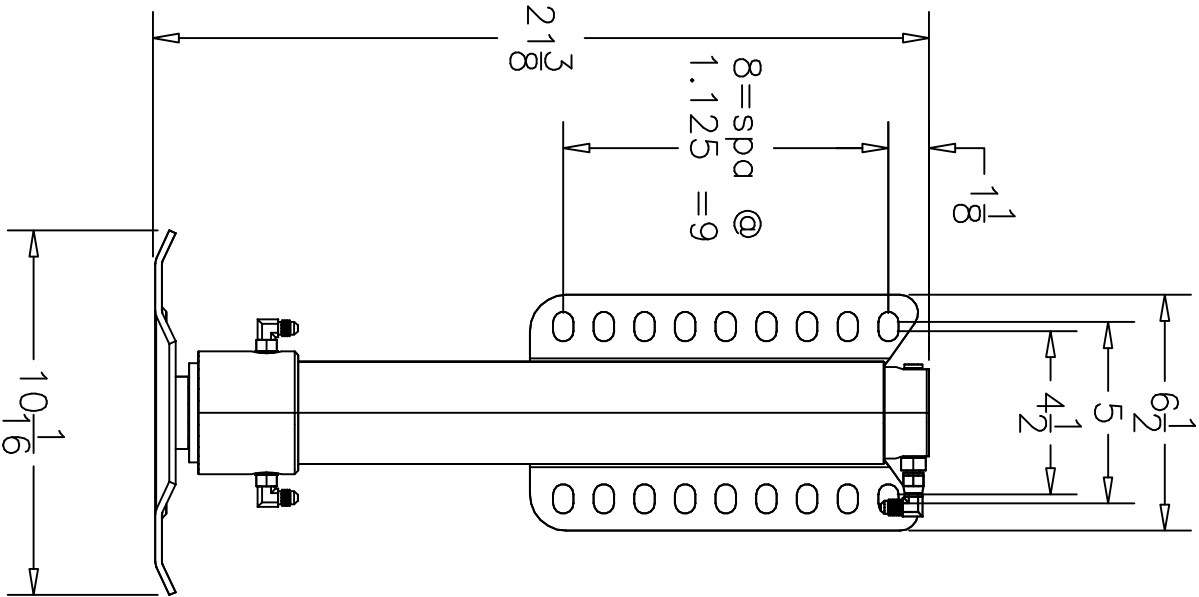

Equalizer

55169 COUNTRY ROAD 3
ELKHART, IN 46515

#

REVISIONS

BY:

DATE:

UNLESS OTHERWISE SPECIFIED:
TOLERANCES:
.XXX ± 0.010
.XX ± 0.030
.X ± 1/2"
REMOVE ALL BURRS AND SHARP EDGES .015 MAX

TITLE

MH 16 SL LEG ASSEMBLY

USED ON:

NEXUS

SIZE SCALE MATERIAL

A 1:1 AS

NOTED

DRW BY: DATE:

SU 3/19/18

PART NAME: SL 16 S-NEXUS

APPD BY DATE:

-

PAGE: 3 OF 3

DWG NO.: P7214

REV:

NOTICE - This drawing, including principles of design, is the property of Doye Corporation, Elkhart, Indiana, with the agreement that it is not to be reproduced, copied, or loaned in any manner that may constitute a detriment directly or indirectly to Doye Corporation. Acceptance of this will be construed as an agreement of the above.

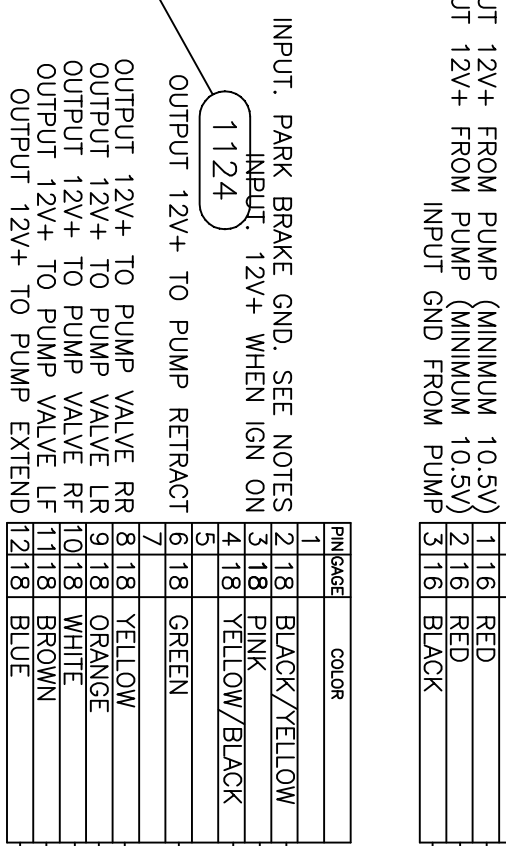
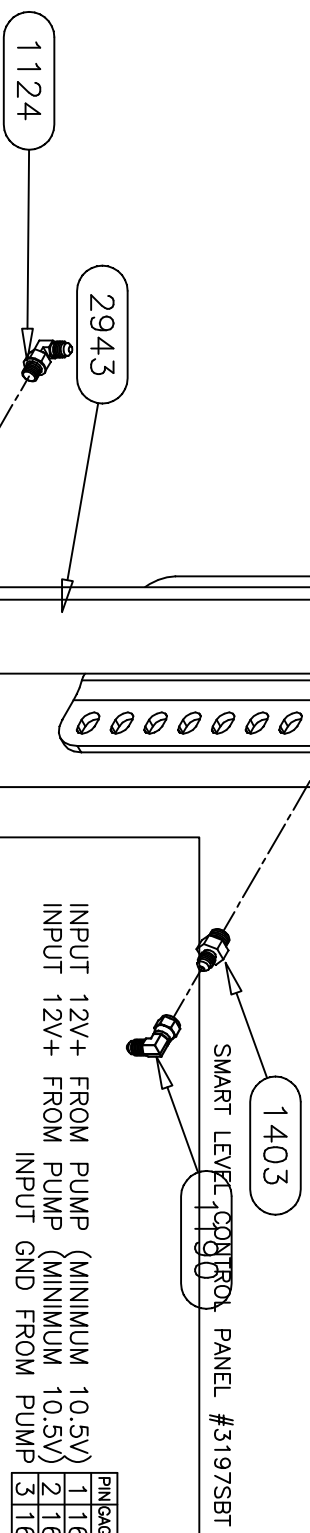

On each pair of jacks in this system, one jack will have (1) 1124 fitting and the other will

hgs09 (20) 12A fitting	
ELKHART, IN 46515	

PIN	GAGE	COLOR
1	16	RED
2	16	RED
3	16	BLACK

PIN	AGE	COLOR
1		
2	18	BLACK/YELLOW
3	18	PINK
4	18	YELLOW/BLACK
5		
6	18	GREEN
7		
8	18	YELLOW
9	18	ORANGE
10	18	WHITE
11	18	BROWN
12	18	BLUE

REVISIONS	
#	

NOTICE - This drawing, including principles of design, is the property of Days Corporation, Elkhart, Indiana, with the agreement that it is not to be reproduced, copied, or loaned in any manner that may constitute a detriment directly or indirectly to Days Corporation. Acceptance of this will be construed as an agreement of the above.

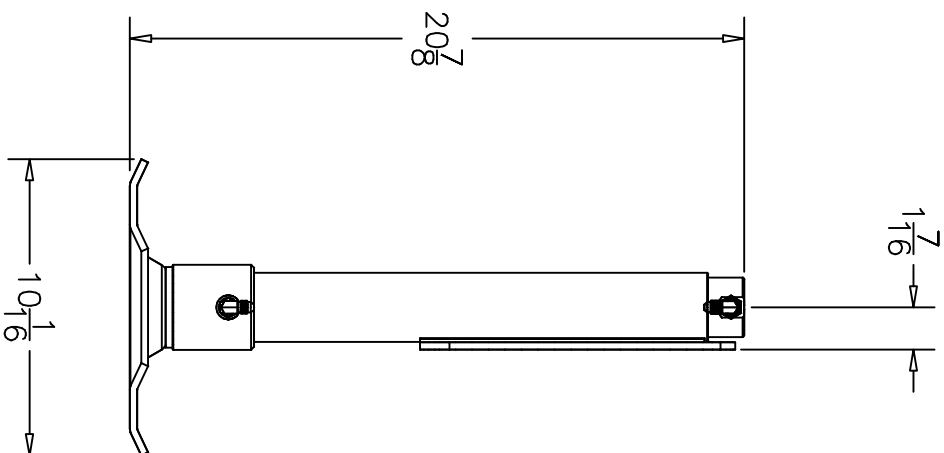
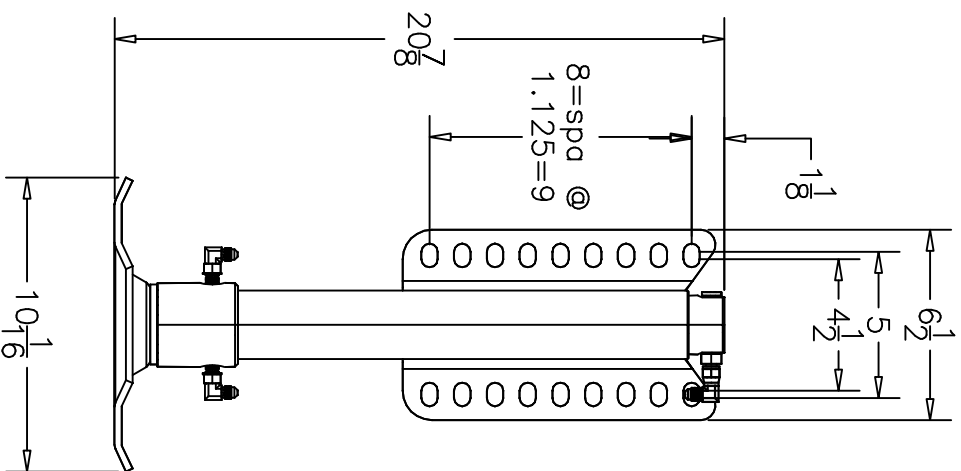

Equalizer

55169 COUNTY ROAD 3
ELKHART, IN 46515

#

REVISIONS

BY:

DATE:

UNLESS OTHERWISE

TITLE

USED ON:

MH 15 SL LEG ASSEMBLY

LIBRARY

SIZE	SCALE	MATERIAL
------	-------	----------

1111

A	1:1	A	S
---	-----	---	---

ZOOTHEID

DRW BY: DATE:

PART NAME: CHAIN ESTIMATION

SC 11A-2371P9/11K

TABLE 1	USDA NLEUG + MEALUS
DATE	2000-2001

NOTE—This drawing, including principles of design, is the property of Doy's Corporation, Elkhart, Indiana, with the agreement that it is not to be reproduced, copied, or loaned in any manner that may constitute a detriment directly or indirectly to Doy's Corporation. Acceptance of this will be construed as an agreement of the above.

INPUT. IGNITION FROM COACH. 12V+ WHEN IGN ON. 18 PINK

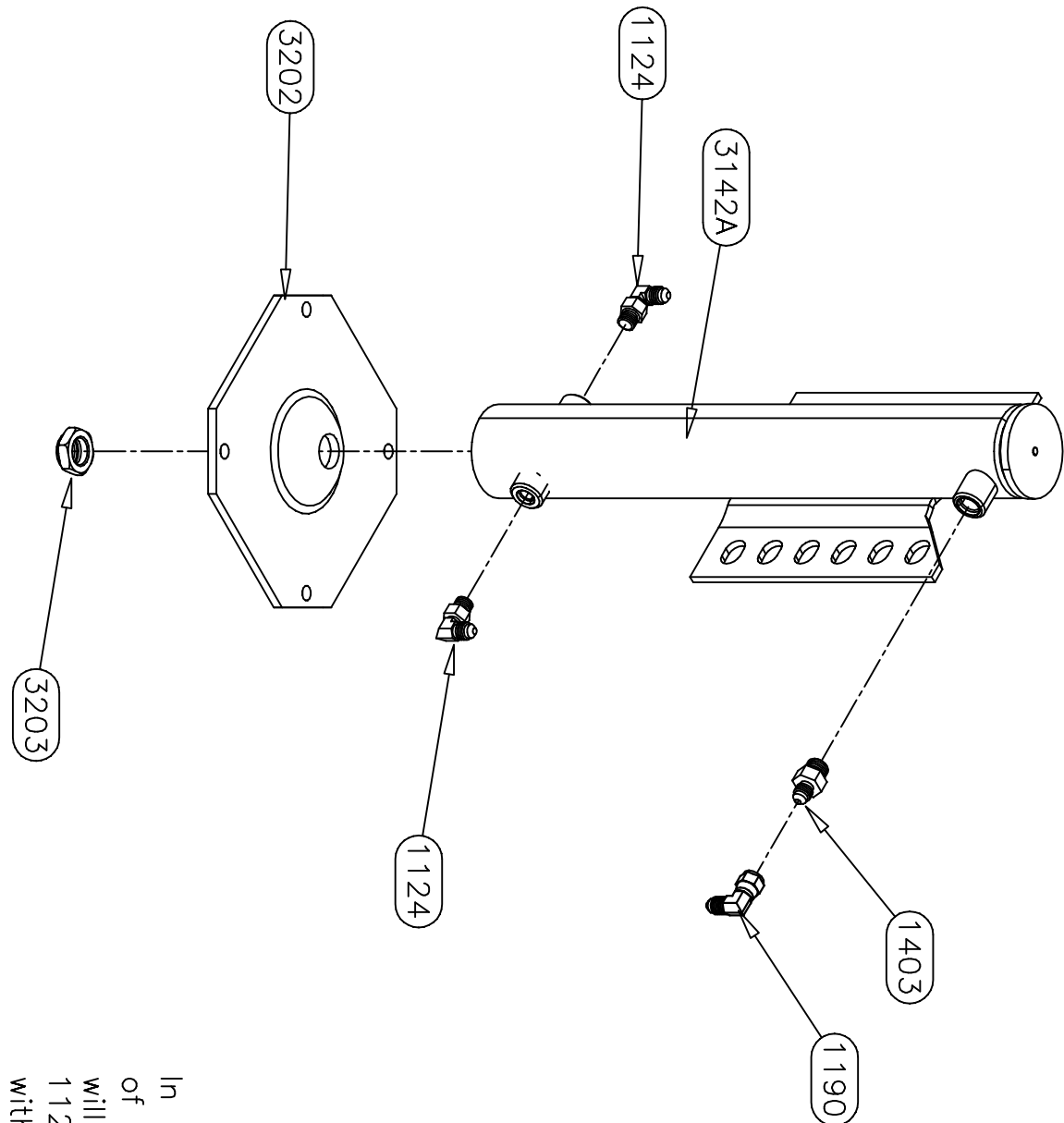

In this system each pair of jacks (front and rear) will have one jack with (1) 1124 fitting and one jack with (2) 1124 fittings.

Equalizer		55169 COUNTRY ROAD 3 ELKHART, IN 46515		#	REVISIONS		BY:	DATE:	UNLESS OTHERWISE SPECIFIED:		TITLE		USED ON:	
NOTICE - This drawing, including principles of design, is the property of Doye Corporation, Elkhart, Indiana, with the agreement that it is not to be reproduced, copied, or loaned in any manner that may constitute a detriment directly or indirectly to Doye Corporation. Acceptance of this will be construed as an agreement of the above.									TOLERANCES:		SL 13 LEG ASSEMBLIES		NEXUS	
									.XXX ± 0.010		SIZE SCALE MATERIAL		NOTED	
									.XX ± 0.010		A 1:1 A S			
									.X ± 0.030		DRW BY: DATE:		PART NAME:	
									ANG. ± 1/2"		SU 3/19/18		SL 13 LP-NEXUS	
									REMOVE ALL BURRS AND SHARP EDGES .015 MAX		APPD BY DATE:		PAGE: 2 OF 3	
													DWG NO.: P7842A	
													REV: -	

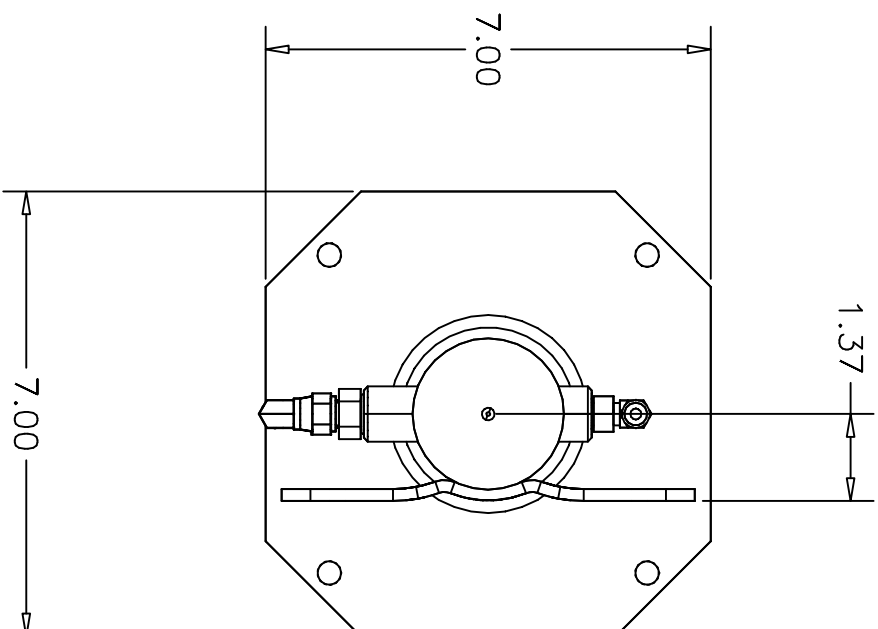
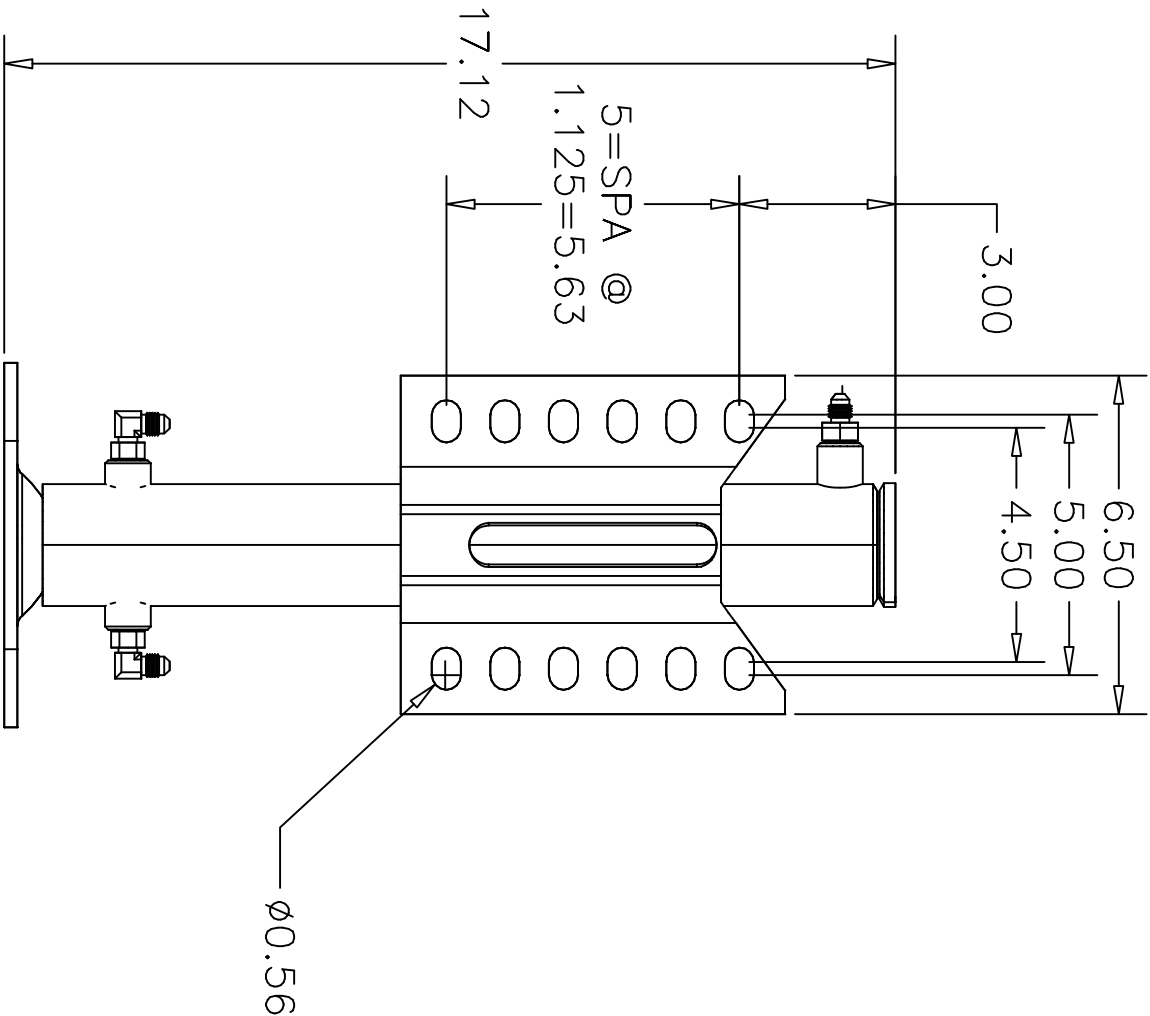

Equalizer		55169 COUNTRY ROAD 3 ELKHART, IN 46515			
#	REVISIONS	BY:	DATE:		
				UNLESS OTHERWISE SPECIFIED:	
				TOLERANCES:	
				.XXX ± 0.010	
				.XX ± 0.010	
				.X ± 0.030	
				ANG. ± 1/2°	
				REMOVE ALL BURRS AND SHARP EDGES .015 MAX	
TITLE		SL 13 LEG ASSEMBLIES		USED ON:	
SIZE SCALE		A 1:1		NEXUS	
MATERIAL		AS			
DRW BY:		SU		NOTED	
DATE:		3/19/18		PART NAME:	
AP'D BY:		—		SL 13 LP-NEXUS	
DATE:		—		PAGE:	
				3 OF 3	
				DWG NO.:	
				P7842A	
				REV:	
				—	

NOTICE - This drawing, including principles of design, is the property of Doye Corporation, Elkhart, Indiana, with the agreement that it is not to be reproduced, copied, or loaned in any manner that may constitute a detriment directly or indirectly to Doye Corporation. Acceptance of this will be construed as an agreement of the above.

Warranty authorization must come directly from Equalizer Systems. (800) 846-9659.

Equalizer

55169 COUNTRY ROAD 3
ELKHART, IN 46515

NOTICE - This drawing, including principles of design, is the property of Dye Corporation, Elkhart, Indiana, with the agreement that it is not to be reproduced, copied, or loaned in any manner that may constitute a detriment directly or indirectly to Dye Corporation. Acceptance of this will be construed as an agreement of the above.

#

REVISIONS

BY:

DATE:

UNLESS OTHERWISE SPECIFIED:

TOLERANCES:

.XXX ± 0.010

.XX ± 0.010

.X ± 0.030

ANG. ± 1/2°

REMOVE ALL BURRS AND SHARP EDGES .015 MAX

TITLE
4 FUNCTION PUMP

USED ON:
VIPER, PHANTOM, MAYBACH, BENTLEY

SIZE SCALE MATERIAL

A 1:1

DRW BY: DATE:

SU 3/20/18

AP'D BY DATE:

—

PART NAME:

PUMP & MAN 4 FUNC BIROT-KS

PAGE: 2 OF 3 DWG NO.: P7948KS REV: —

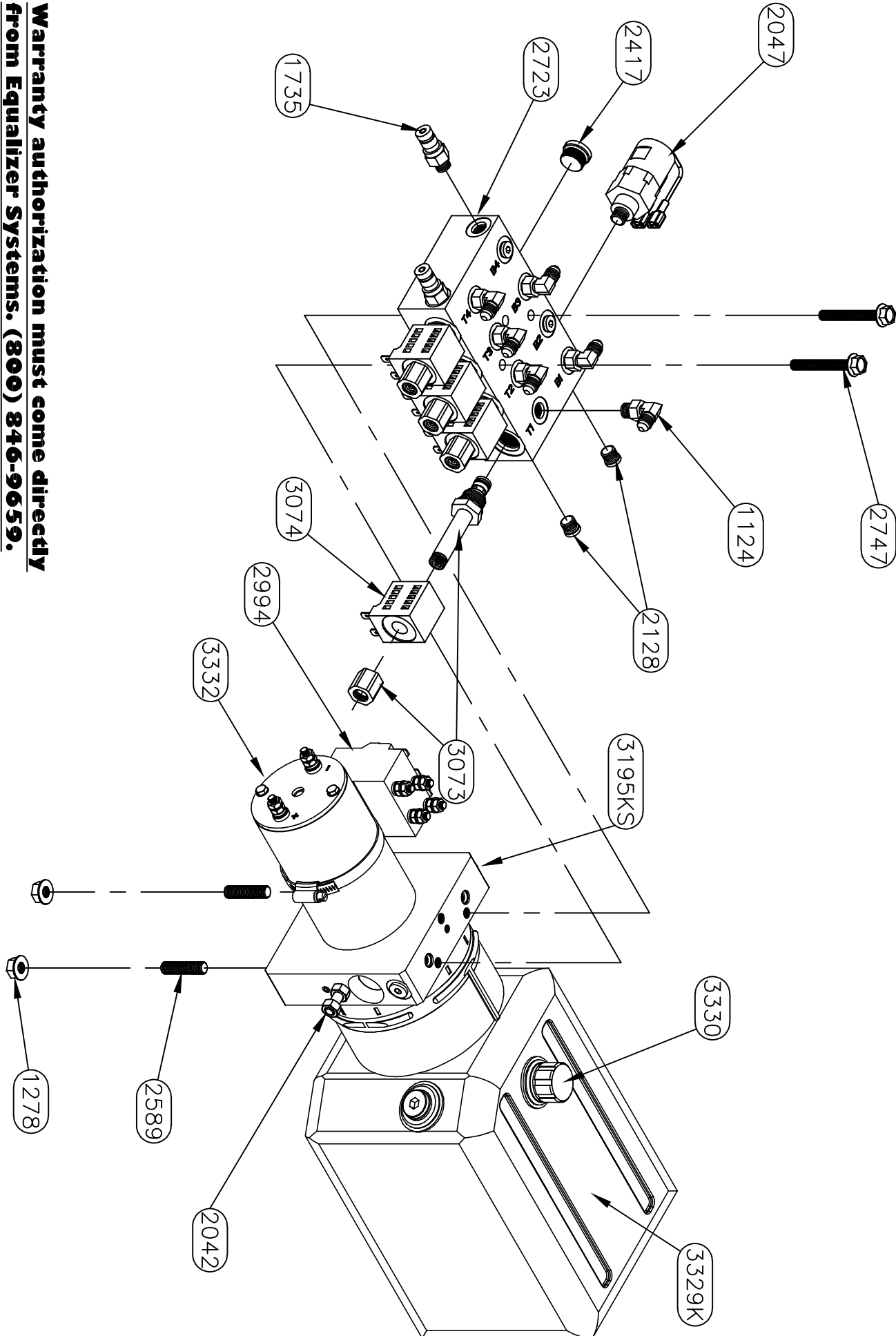

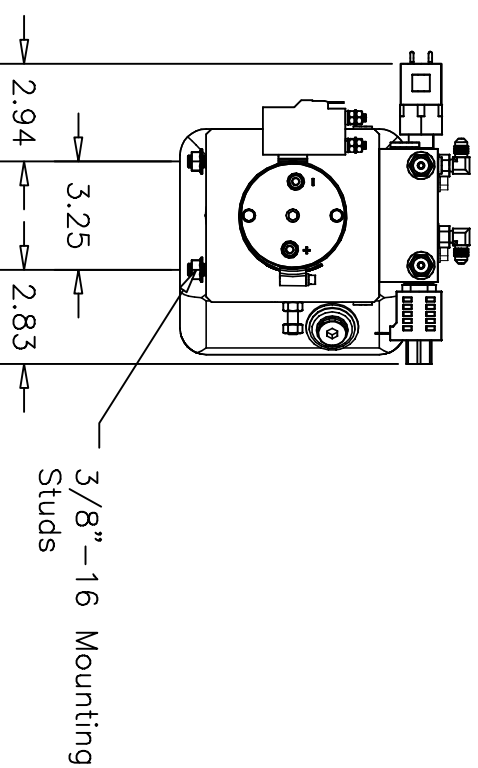
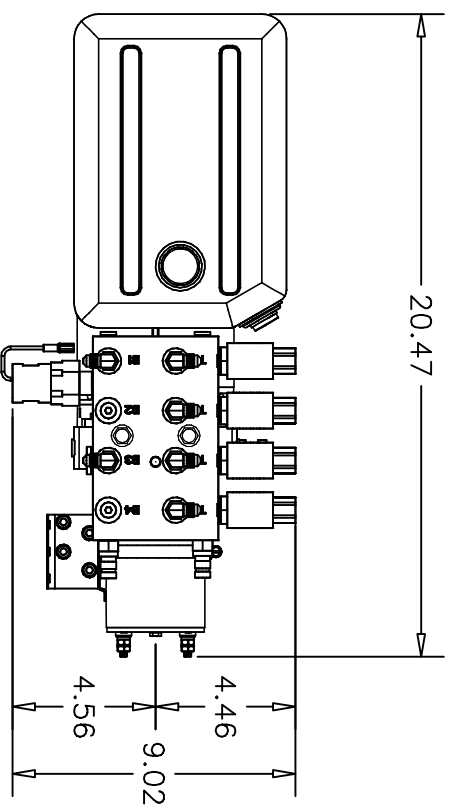
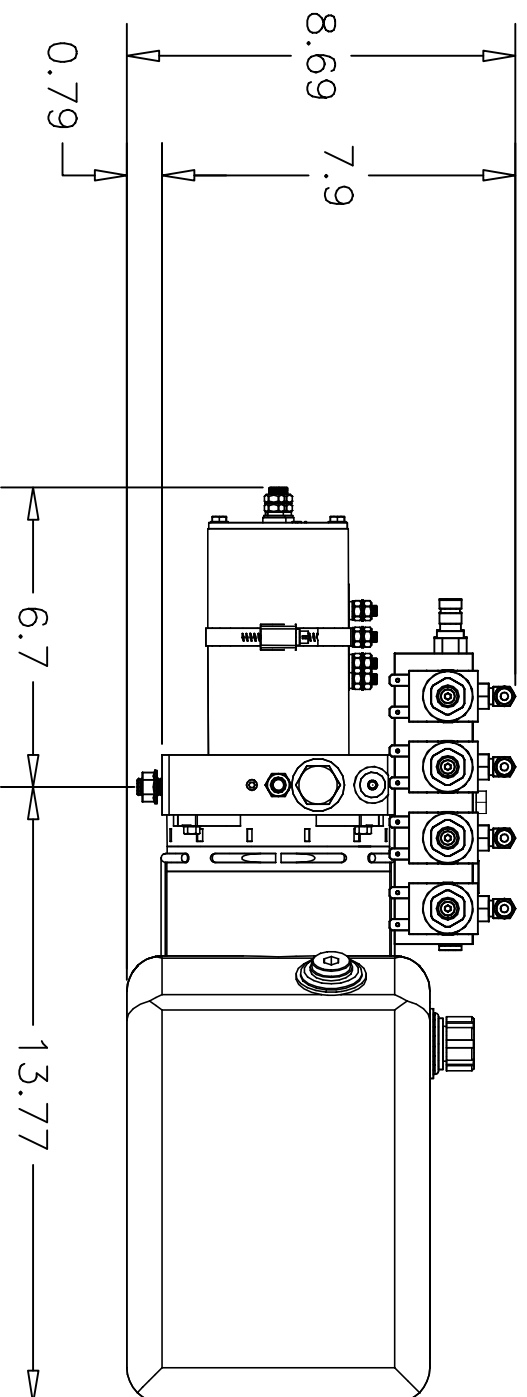

Equalizer

55169 COUNTRY ROAD 3
ELKHART, IN 46515

#

REVISIONS

BY:

DATE: _____

UNLESS OTHERWISE

SPECIFIED:
TOLERANCES:

.XXX	±	0.010
.XX	±	0.010

	Mean	SE
XX	0.010	± 0.010
X	0.030	± 0.030

ANG. $\pm 1/2^\circ$

OVER ALL BURRS

RP EDGES .015

TITLE
4 FUNCTION PUMP

USED ON:
VIPER, PHANTOM, MAYBACH, BENTLEY

SIZE	SCALE	MATERIAL
------	-------	----------

$$\begin{array}{c|c} A & \\ \hline 1 & 1 \\ \hline \end{array}$$

DRW BY:	DATE:
---------	-------

3/20/1

APP'D BY	DATE:
----------	-------

1	1
---	---

PART NAME:

PUMP & MAN 4 FUNC BIROT-KS

PAGE:	DWG NO.:	REV
-------	----------	-----

3 OF 3	P7948KS	1
--------	---------	---

NOTICE - This drawing, including principles of design, is the property of Doy's Corporation, Elkhart, Indiana, with the agreement that it is not to be reproduced, copied, or loaned in any manner that may constitute a detriment directly or indirectly to Doy's Corporation. Acceptance of this will be construed as an agreement of the above.

REV

HYDRAULIC HOSE CONNECTIONS 7948KS PUMP

B = RETRACT FUNCTION

B1 = LEFT FRONT JACK
(BROWN/BLACK)

B3 = LEFT REAR JACK
(ORANGE/BLACK)

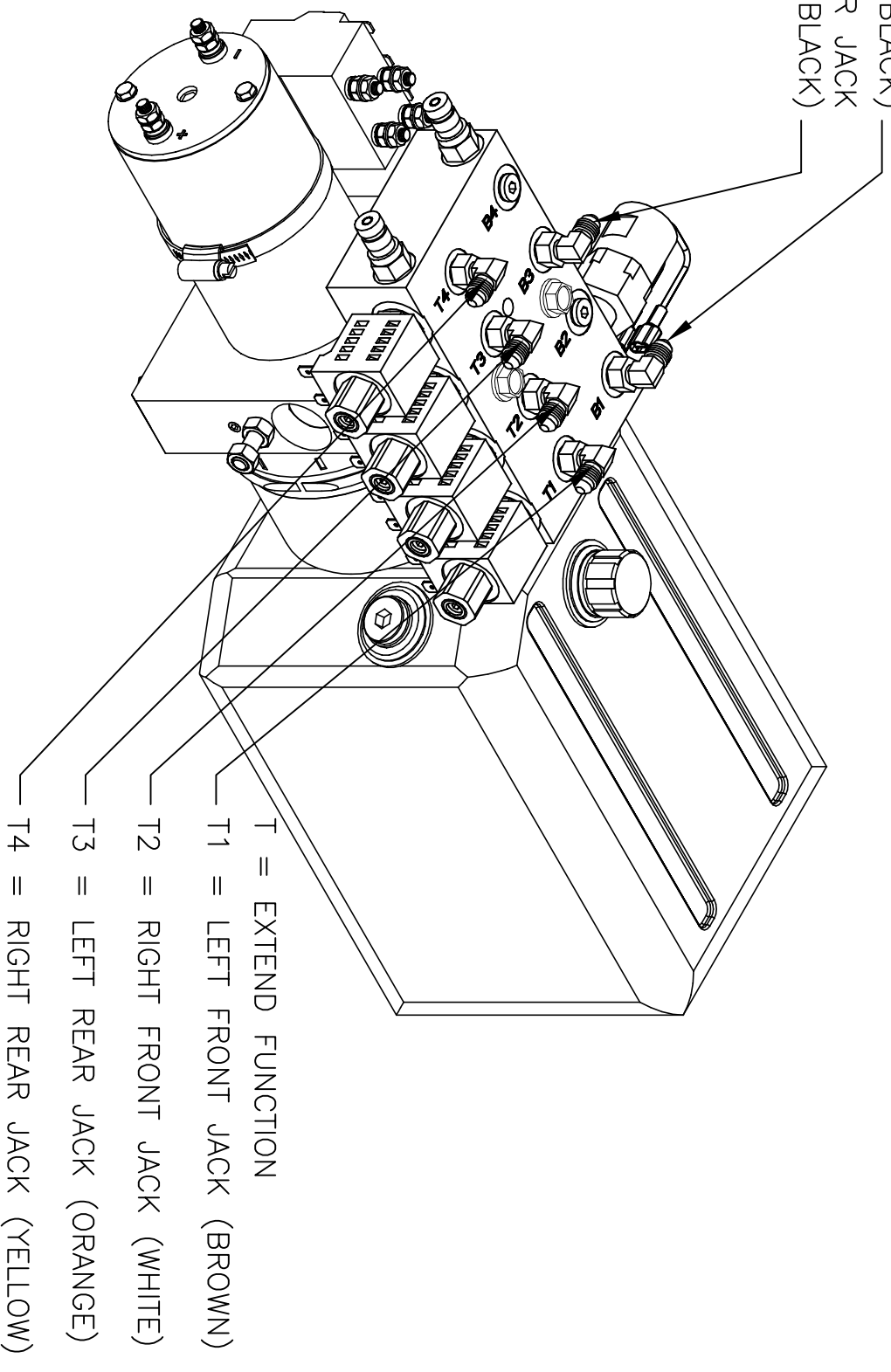

T = EXTEND FUNCTION

T1 = LEFT FRONT JACK (BROWN)

T2 = RIGHT FRONT JACK (WHITE)

T3 = LEFT REAR JACK (ORANGE)

T4 = RIGHT REAR JACK (YELLOW)

7948KS PUMP WIRING

MANUAL OVERRIDE SCREWS

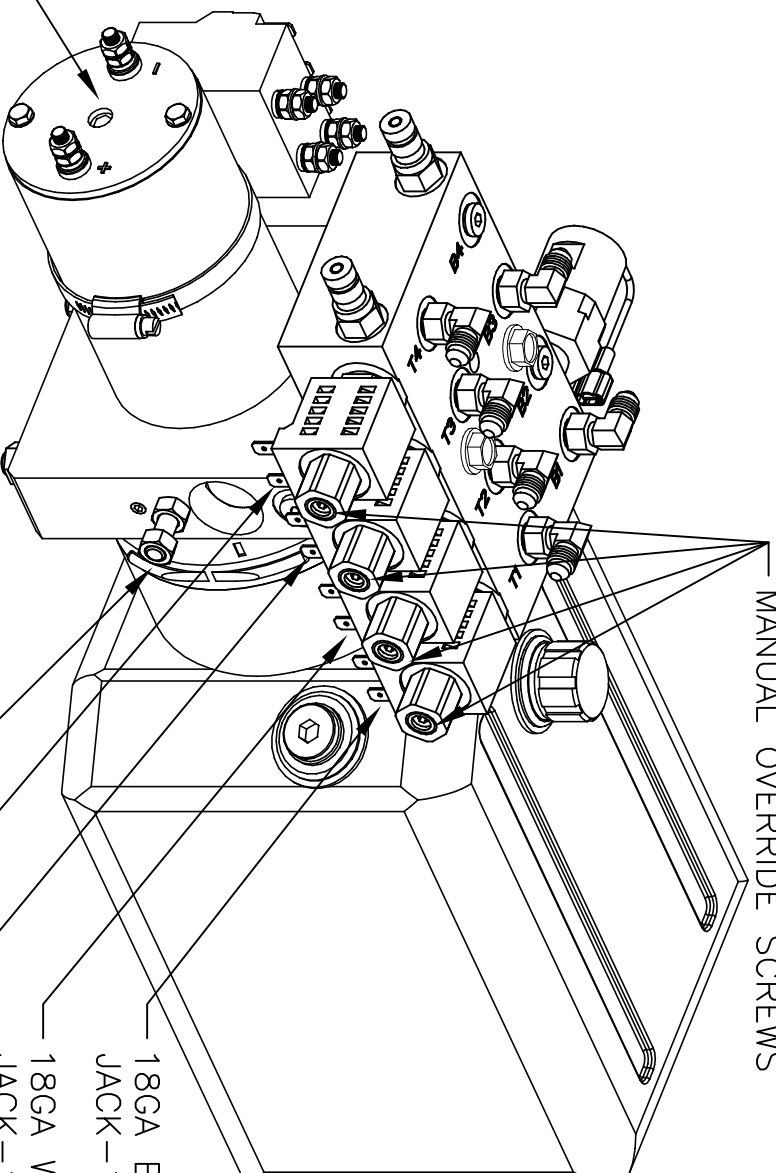

1/4" ALLEN SOCKET MANUAL
OVERRIDE LOCATED UNDER
STICKER

18GA BROWN 12VDC LEFT FRONT
JACK-16GA BLACK GROUND
18GA WHITE 12VDC RIGHT FRONT
JACK-16GA BLACK GROUND
18GA ORANGE 12VDC LEFT REAR
JACK-16GA BLACK GROUND
18GA YELLOW 12VDC RIGHT REAR
JACK-16GA BLACK GROUND
GROUND STUD FOR PUMP ASSEMBLY

TO A2+ STUD ON MOTOR

B1

B2

B3

B4

TO A1- STUD ON MOTOR

12VDC + FROM BATTERY

16 GA BLUE 12VDC EXTEND

16 GA BLACK GROUND

16 GA GREEN 12VDC RETRACT

TO GROUND
STUD ON PUMP

Small Bi-Rotational Pump Assembly

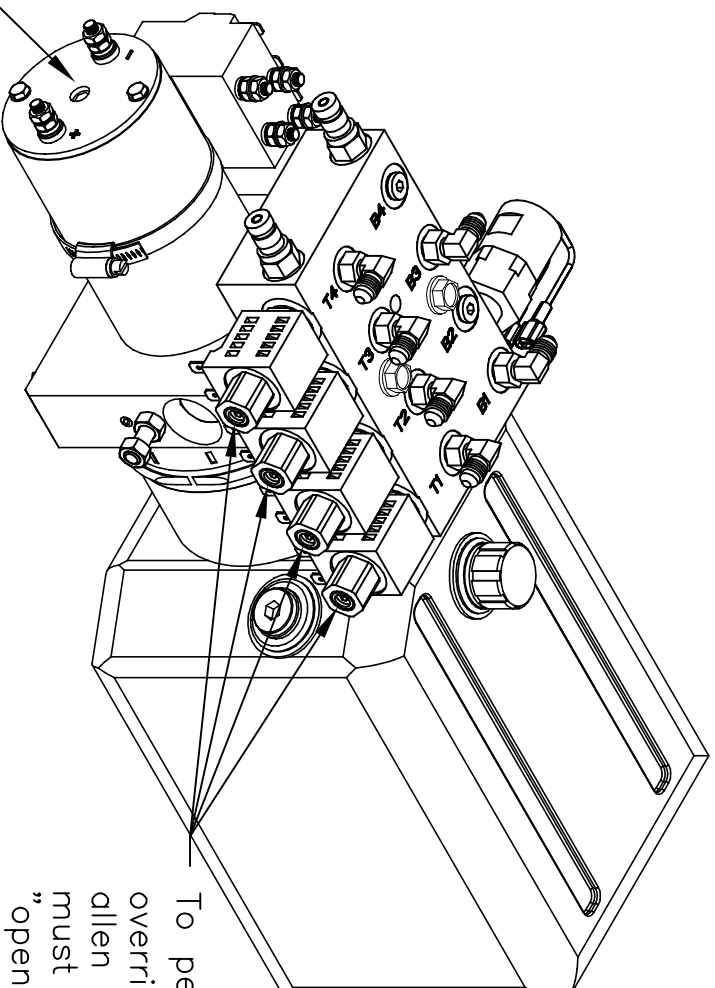

Manual override screw, $\frac{1}{4}$ " allen head, is under this sticker. Using a 2000 rpm minimum drill, retract jacks by turning counter clockwise. To extend, turn screw clockwise.

To perform the manual override procedure, using a $\frac{1}{8}$ " allen wrench, all set screws must be turned clockwise "open" until they are snug. Once all levelers are retracted, turn all valve screws counter clockwise "closed" until snug.

Warranty authorization must come directly from Equalizer Systems. (800) 846-9659.

Equalizer

55169 COUNTRY ROAD 3
ELKHART, IN 46515

NOTICE - This drawing, including principles of design, is the property of Dye Corporation, Elkhart, Indiana, with the agreement that it is not to be reproduced, copied, or loaned in any manner that may constitute a detriment directly or indirectly to Dye Corporation. Acceptance of this will be construed as an agreement of the above.

#

REVISIONS

BY:

DATE:

UNLESS OTHERWISE SPECIFIED:
TOLERANCES:
.XXX ± 0.010
.XX ± 0.010
.X ± 0.030
ANG. ± 1/2°
REMOVE ALL BURRS AND SHARP EDGES .015 MAX

TITLE
4 FUNCTION PUMP

USED ON:
WRAITH, GHOST

SIZE SCALE MATERIAL
A 1: 1

DRW BY: DATE:
SU 3/20/18

PART NAME:
PUMP & MAN 4 FUNC BIROT-KS

PAGE: DWG NO.:
2 OF 3 P70127

REV:

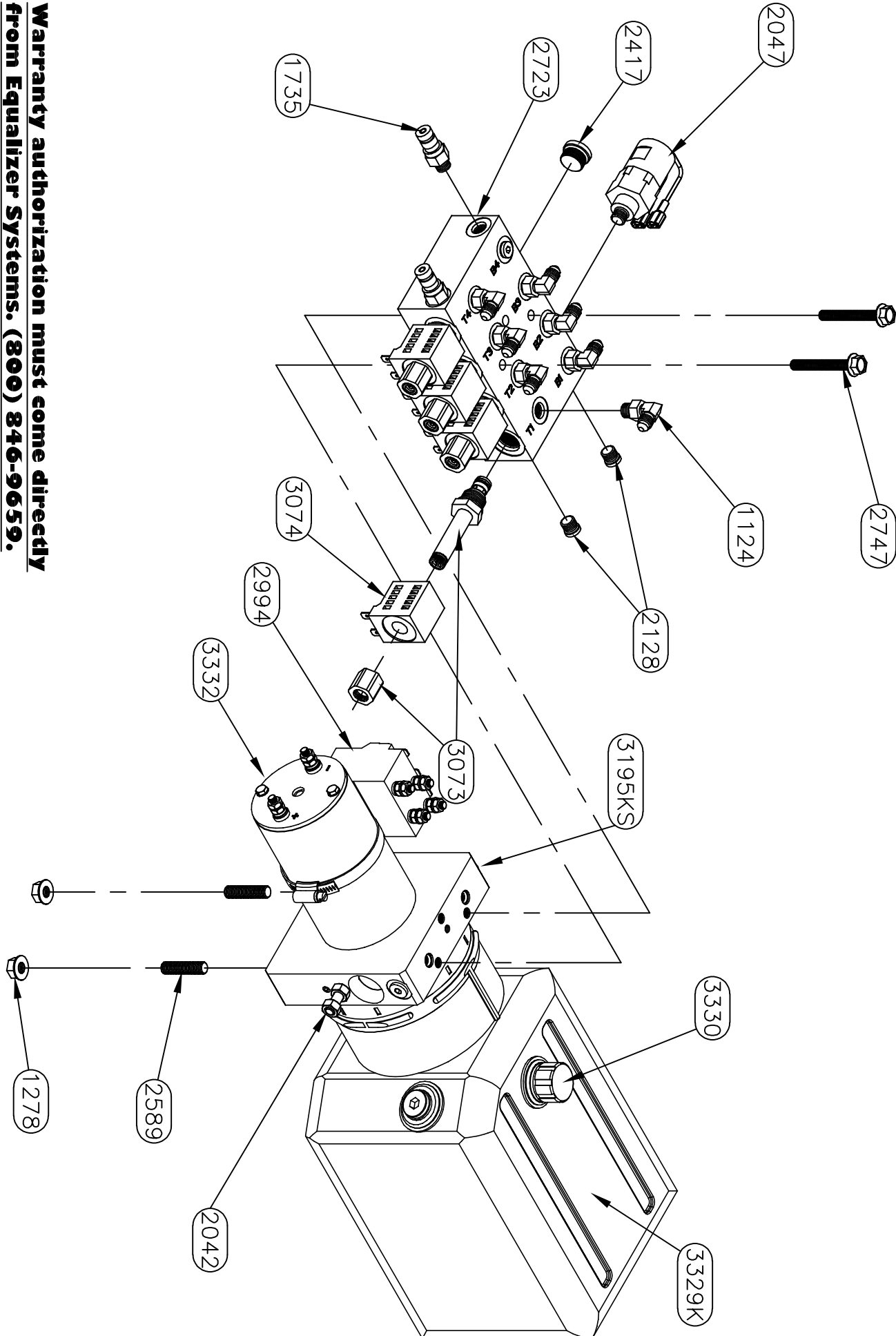

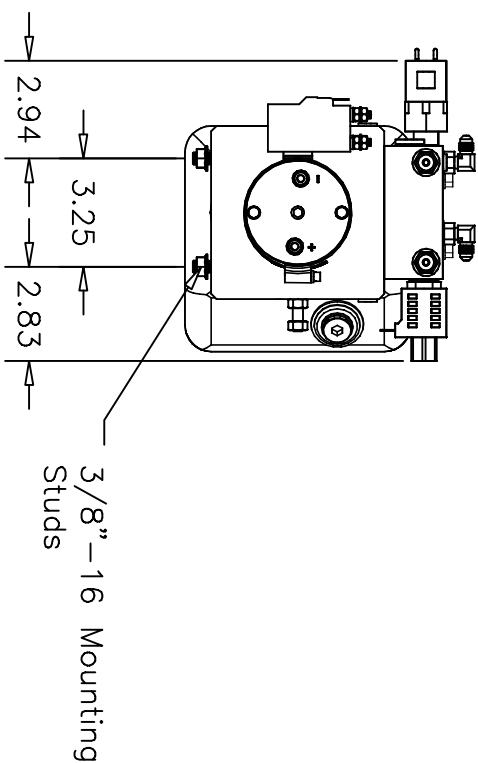
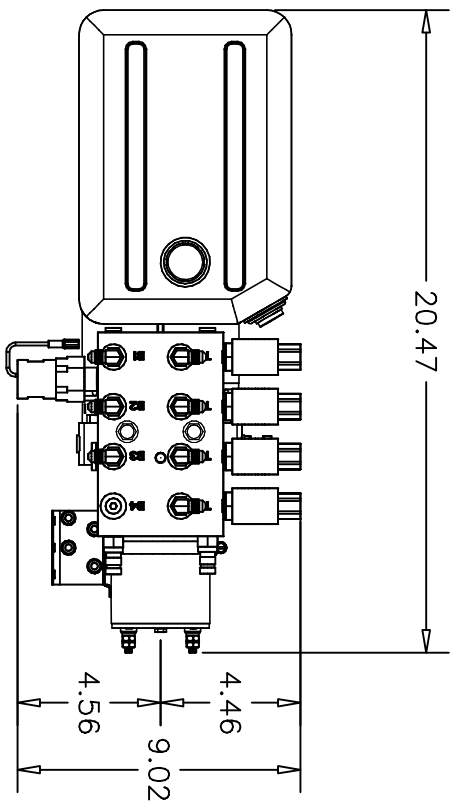
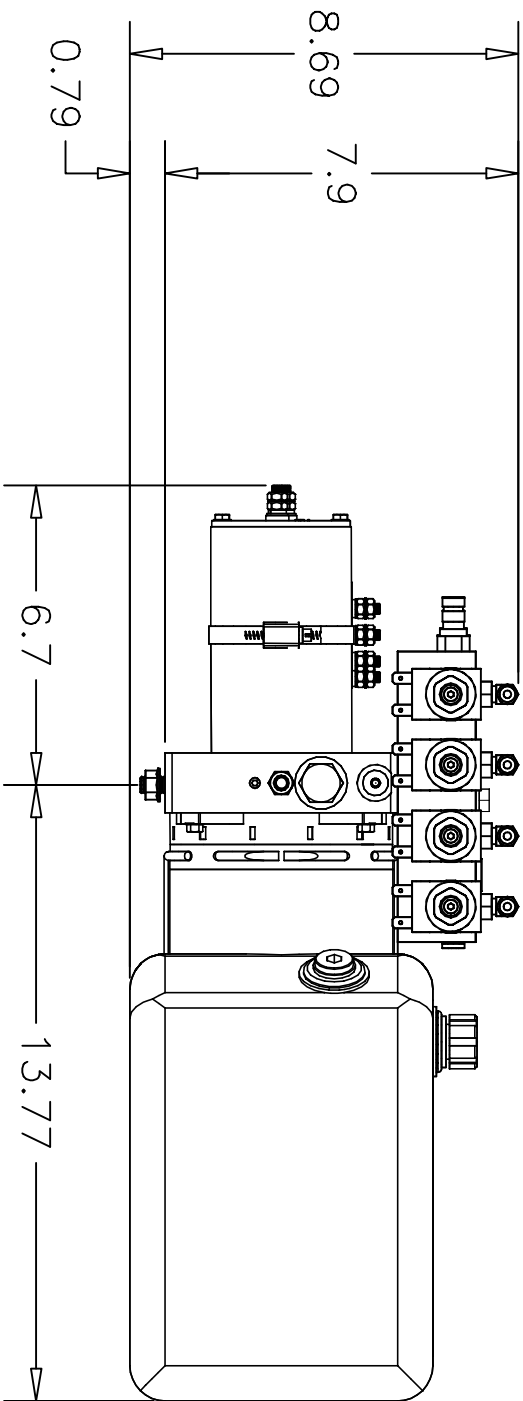

Equalizer		55169 COUNTRY ROAD 3		#		REVISIONS		BY:		DATE:		UNLESS OTHERWISE SPECIFIED:		TITLE		USED ON:	
ELKHART, IN 46515												TOLERANCES:		4 FUNCTION PUMP		WRAITH, GHOST	
												SIZE SCALE MATERIAL		A 1: 1			
												.XXX ± 0.010		DATE:		PART NAME:	
												.XX ± 0.010		3/20/18		PUMP & MAN 4 FUNC BIROT-KS	
												.X ANG. ± 1/2"		AP'D BY DATE:		PAGE:	
												REMOVE ALL BURRS AND SHARP EDGES .015 MAX		—		3 OF 3	
																DWG NO.: P70127	
																REV:	

NOTICE - This drawing, including principles of design, is the property of Dye Corporation, Elkhart, Indiana, with the agreement that it is not to be reproduced, copied, or loaned in any manner that may constitute a detriment directly or indirectly to Dye Corporation. Acceptance of this will be construed as an agreement of the above.

HYDRAULIC HOSE CONNECTIONS 70127KS PUMP

B = RETRACT FUNCTION

B1 = LEFT FRONT JACK
(BROWN/BLACK)

B2 = RIGHT FRONT JACK
(WHITE/BLACK)

B3 = LEFT REAR JACK
(ORANGE/BLACK)

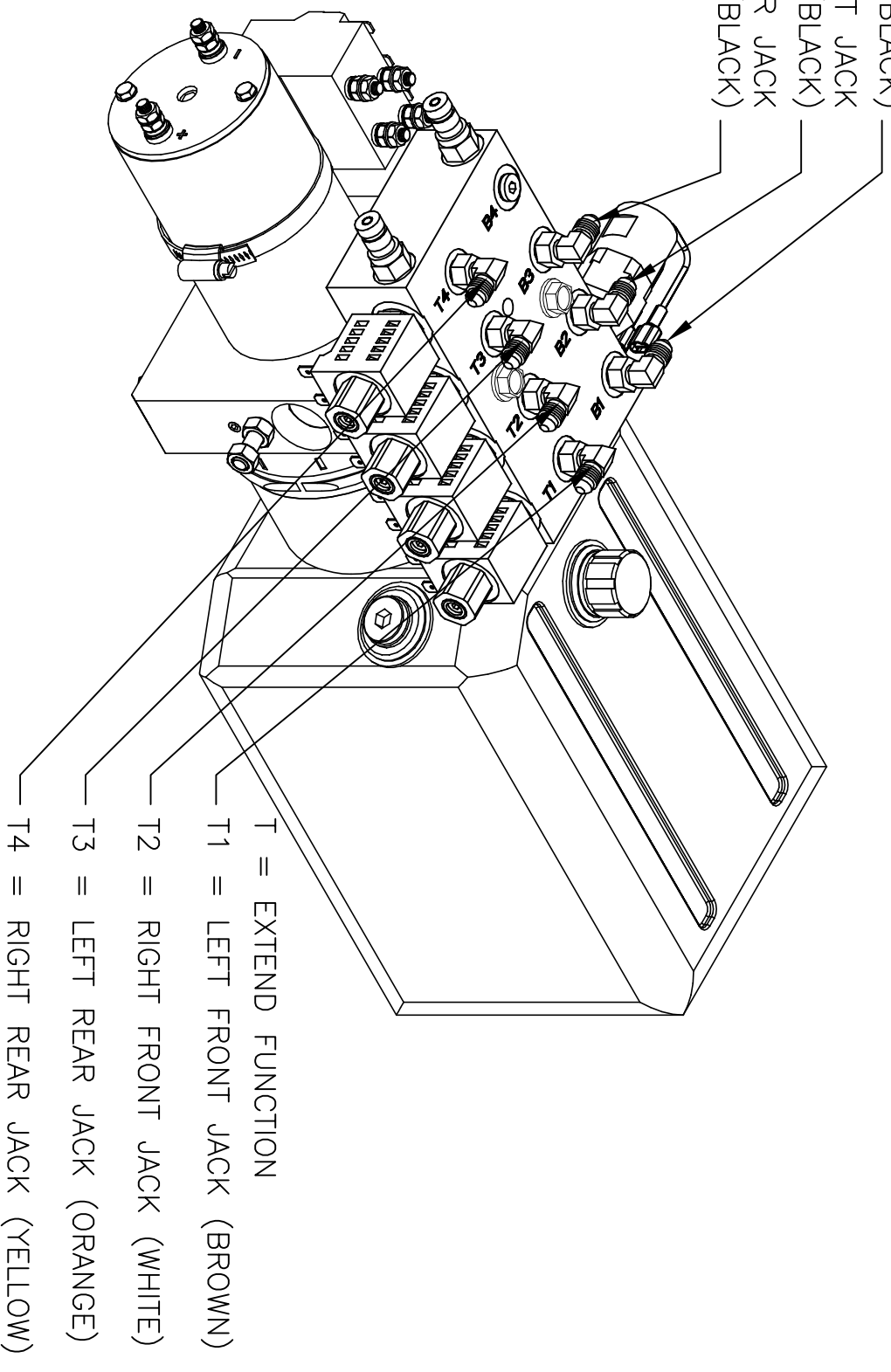

T = EXTEND FUNCTION

T1 = LEFT FRONT JACK (BROWN)

T2 = RIGHT FRONT JACK (WHITE)

T3 = LEFT REAR JACK (ORANGE)

T4 = RIGHT REAR JACK (YELLOW)

70127KS PUMP WIRING

MANUAL OVERRIDE SCREWS

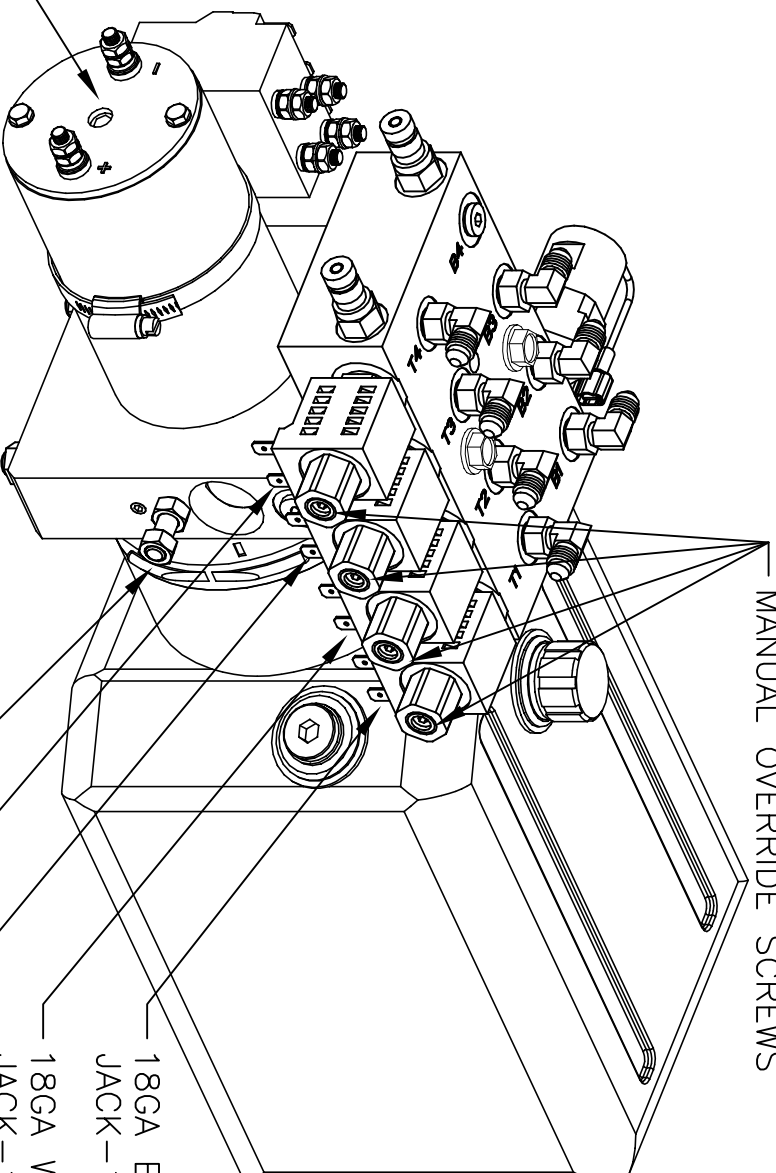

1/4" ALLEN SOCKET MANUAL
OVERRIDE LOCATED UNDER
STICKER

18GA BROWN 12VDC LEFT FRONT
JACK-16GA BLACK GROUND
18GA WHITE 12VDC RIGHT FRONT
JACK-16GA BLACK GROUND
18GA ORANGE 12VDC LEFT REAR
JACK-16GA BLACK GROUND
18GA YELLOW 12VDC RIGHT REAR
JACK-16GA BLACK GROUND
GROUND STUD FOR PUMP ASSEMBLY

TO A2+ STUD ON MOTOR

TO A1- STUD ON MOTOR

12VDC + FROM BATTERY

16 GA BLUE 12VDC EXTEND

16 GA BLACK GROUND

16 GA GREEN 12VDC RETRACT

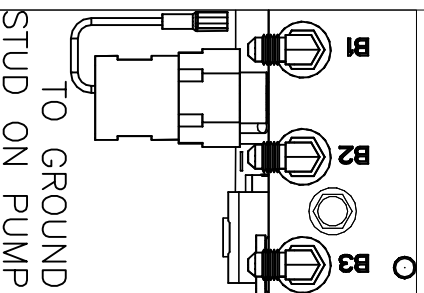

Small Bi-Rotational Pump Assembly

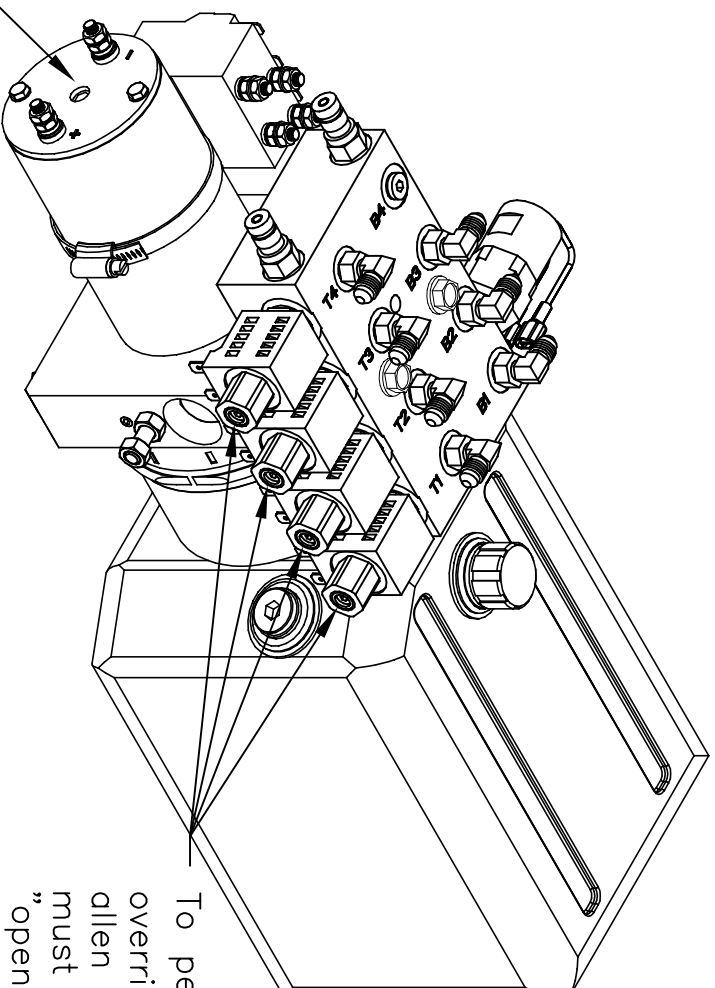

Manual override screw, $\frac{1}{4}$ " allen head, is under this sticker. Using a 2000 rpm minimum drill, retract jacks by turning counter clockwise. To extend, turn screw clockwise.

To perform the manual override procedure, using a $\frac{1}{8}$ " allen wrench, all set screws must be turned clockwise "open" until they are snug. Once all levelers are retracted, turn all valve screws counter clockwise "closed" until snug.

70114 PARTS LIST

ITEM	PART #	DESCRIPTION	QUAN	COLOR CODE	LOCATION
1	2465	HOSE-10'	1	ORANGE STRIPE/YELLOW STRIPE	BOTTOM OF LR JACK TO BOTTOM OF RR JACK
2	2465	HOSE-10'	1	BROWN STRIPE/WHITE STRIPE	BOTTOM OF LF JACK TO BOTTOM OF RF JACK
3	2465	HOSE-10'	1	BROWN SOLID	PUMP PORT T1 TO TOP OF LF JACK
4	2467	HOSE-12'	1	BROWN STRIPE	PUMP PORT B1 TO BOTTOM OF LF JACK
5	2473	HOSE-18'	1	ORANGE SOLID	PUMP PORT T3 TO TOP OF LR JACK
6	2475	HOSE-20'	1	ORANGE STRIPE	PUMP PORT B3 TO BOTTOM OF LR JACK
7	2469	HOSE-14'	1	WHITE SOLID	PUMP PORT T2 TO TOP OF RF JACK
8	2475	HOSE-20'	1	YELLOW SOLID	PUMP PORT T4 TO TOP OF RR JACK

REQUIRED JACK FITTINGS

ITEM	PART #	DESCRIPTION	QUAN
9	1124	FITTING-#4 JIC X #4 OR MALE 90	6
10	1190	FITTING-#4 X #4 JIC SWIVEL 90	4
11	1403	FITTING-RESTRICTOR #6 X #4-042 ORIFICE	4

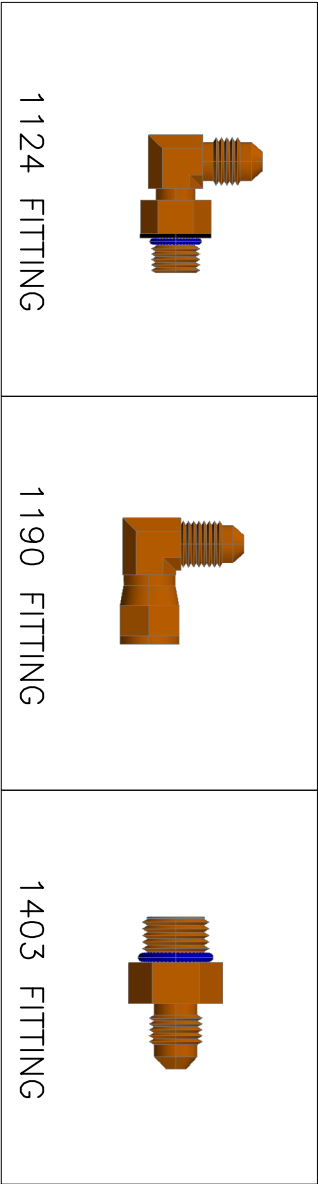

Warranty authorization must come directly from Equalizer Systems. (800) 846-9659.

Equalizer 55169 COUNTRY ROAD 3 ELKHART, IN 46515	#	REVISIONS		BY:	DATE:	TITLE		USED ON:		
NOTICE - This drawing, including principles of design, is the property of Doye Corporation, Elkhart, Indiana, with the agreement that it is not to be reproduced, copied, or loaned in any manner that may constitute a detriment directly or indirectly to Doye Corporation. Acceptance of this will be construed as an agreement of the above.						UNLESS OTHERWISE SPECIFIED: TOLERANCES: .XXX ± 0.010 .XX ± 0.020 .X ± 1/2" ANG. ± 1/2" REMOVE ALL BURRS AND SHARP EDGES .015 MAX		SIZE SCALE A 1:1	HOSE CHART MATERIAL AS	NOTE PART NAME: HOSE KIT-NEXUS 8438 PAGE: 1 OF 2 DWG NO.: P70114

70123 PARTS LIST

ITEM	PART #	DESCRIPTION	QUAN	COLOR CODE	LOCATION
1	2461	HOSE-6'	1	ORANGE STRIPE/YELLOW STRIPE	BOTTOM OF LR JACK TO BOTTOM OF RR JACK
2	2463	HOSE-8'	1	BROWN STRIPE/WHITE STRIPE	BOTTOM OF LF JACK TO BOTTOM OF RF JACK
3	2467	HOSE-12'	1	BROWN SOLID	PUMP PORT T1 TO TOP OF LF JACK
4	2467	HOSE-12'	1	BROWN STRIPE	PUMP PORT B1 TO BOTTOM OF LF JACK
5	2469	HOSE-14'	1	ORANGE SOLID	PUMP PORT T3 TO TOP OF LR JACK
6	2471	HOSE-16'	1	ORANGE STRIPE	PUMP PORT B3 TO BOTTOM OF LR JACK
7	2469	HOSE-14'	1	WHITE SOLID	PUMP PORT T2 TO TOP OF RF JACK
8	2473	HOSE-18'	1	YELLOW SOLID	PUMP PORT T4 TO TOP OF RR JACK

REQUIRED JACK FITTINGS

ITEM	PART #	DESCRIPTION	QUAN
9	1124	FITTING-#4 JIC X #4 OR MALE 90	6
10	1190	FITTING-#4 X #4 JIC SWIVEL 90	4
11	1403	FITTING-RESTRICTOR #6 X #4-042 ORIFICE	4

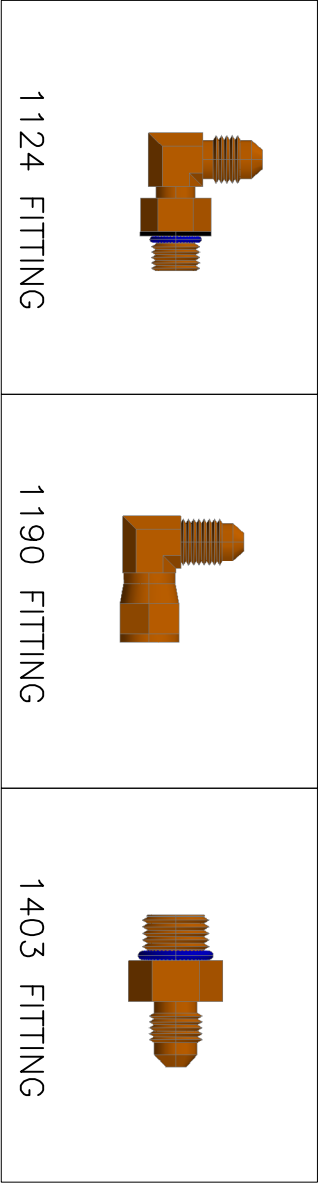

Warranty authorization must come directly from Equalizer Systems. (800) 846-9659.

Equalizer 55169 COUNTRY ROAD 3 ELKHART, IN 46515	#	REVISIONS		BY:	DATE:	TITLE		USED ON:		
						NEXUS HOSE CHART		VIPER, PHANTOM		
						SIZE SCALE MATERIAL				
						A 1:1 A S				
						DRW BY: DATE: 6/14/18		PART NAME: HOSE KIT-NEXUS 8433		
NOTICE - This drawing, including principles of design, is the property of Doye Corporation, Elkhart, Indiana, with the agreement that it is not to be reproduced, copied, or loaned in any manner that may constitute a detriment directly or indirectly to Doye Corporation. Acceptance of this will be construed as an agreement of the above.						REMOVE ALL BURRS AND SHARP EDGES .015 MAX		PAGE: 1 OF 2	DWG NO.: P70123	REV: -

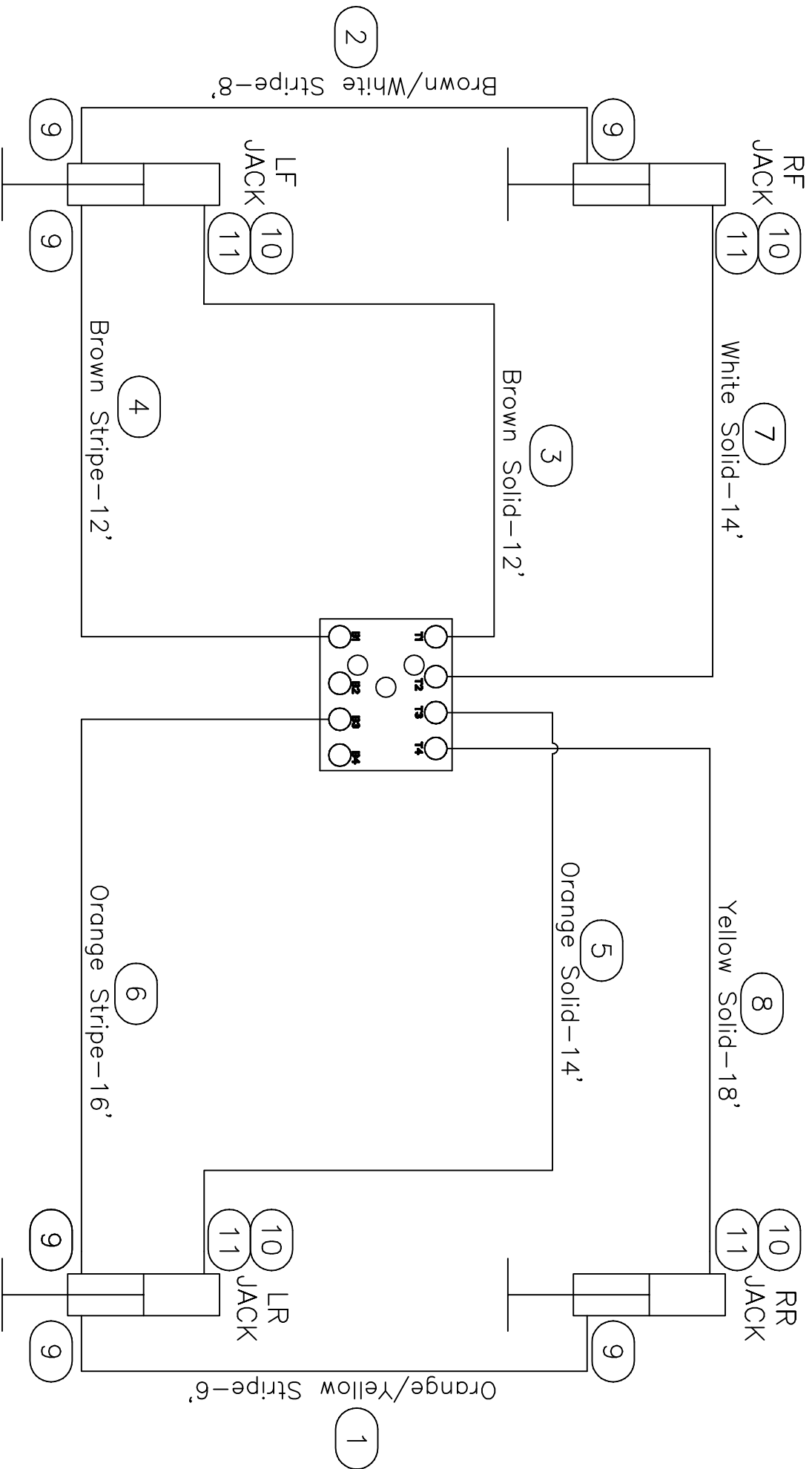

Equalizer		55169 COUNTY ROAD 3 ELKHART, IN 46515		#		REVISIONS		BY:		DATE:		UNLESS OTHERWISE SPECIFIED: TOLERANCES: .XXX ± 0.010 .XX ± 0.010 .X ± 0.020 ANG. ± 1/2" REMOVE ALL BURRS AND SHARP EDGES .015 MAX		TITLE NEXUS HOSE CHART		USED ON: VIPER, PHANTOM	
												SIZE SCALE MATERIAL A N/A A S		NOTED			
												DRW BY: 6/14/18		DATE: 6/14/18		PART NAME: HOSE KIT-NEXUS 8433	
												PAGE: 2 OF 2		DWG NO.: P70123		REV: -	

NOTICE - This drawing, including principles of design, is the property of Doye Corporation, Elkhart, Indiana, with the agreement that it is not to be reproduced, copied, or loaned in any manner that may constitute a detriment directly or indirectly to Doye Corporation. Acceptance of this will be construed as an agreement of the above.

Warranty authorization must come directly from Equalizer Systems. (800) 846-9659.

ITEM	PART #	DESCRIPTION	QUAN	COLOR CODE	LOCATION
1	2461	HOSE-6'	1	BROWN SOLID	PUMP PORT T1 TO TOP OF LF JACK
2	2463	HOSE-8'	1	BROWN STRIPE	PUMP PORT B1 TO BOTTOM OF LF JACK
3	2463	HOSE-8'	1	ORANGE STRIPE/YELLOW STRIPE	BOTTOM OF LR JACK TO BOTTOM OF RR JACK
4	2465	HOSE-10'	1	WHITE SOLID	PUMP PORT T2 TO TOP OF RF JACK
5	2467	HOSE-12'	1	WHITE STRIPE	PUMP PORT B2 TO BOTTOM OF RF JACK
6	2473	HOSE-18'	1	ORANGE SOLID	PUMP PORT T3 TO TOP OF LR JACK
7	2475	HOSE-20'	1	ORANGE STRIPE	PUMP PORT B3 TO BOTTOM OF LR JACK
8	2476	HOSE-22'	1	YELLOW SOLID	PUMP PORT T4 TO TOP OF RR JACK

ITEM	PART#	DESCRIPTION	QUAN
9	1124	FITTING-#4 JIC X #4 OR MALE 90	5
10	1190	FITTING-#4 X #4 JIC SWIVEL 90	4
11	1403	FITTING-RESTRICTOR #6 X #4-042 ORIFICE	4

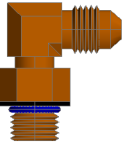
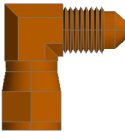
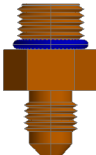
1124 FITTING	
1190 FITTING	
1403 FITTING	

Warranty authorization must come directly from Equalizer Systems. (800) 846-9659.

<i>Equalizer</i>		55169 COUNTRY ROAD 3 ELKHART, IN 46515	
#		REVISIONS	
		BY:	DATE:
		UNLESS OTHERWISE SPECIFIED:	
		TOLERANCES:	
		XXX ± 0.010	
		XX ± 0.010	
		X ± 0.030	
		ANG. ± 1/32	
		REMOVE ALL BURRS AND SHARP EDGES .015 MAX	
TIME	HOSE CHART	USED ON:	
NEXUS		GHOST, WRAITH	
SIZE SCALE	MATERIAL	NOTED	
A 1:1	A S		
DRW BY:	DATE:	PART NAME:	
SU	6/15/18	HOSE KIT-NEXUS	8439
APPD BY:	DATE:	PAGE:	DWG NO.:
—	—	1 OF 2	P70129
			REV:
			—

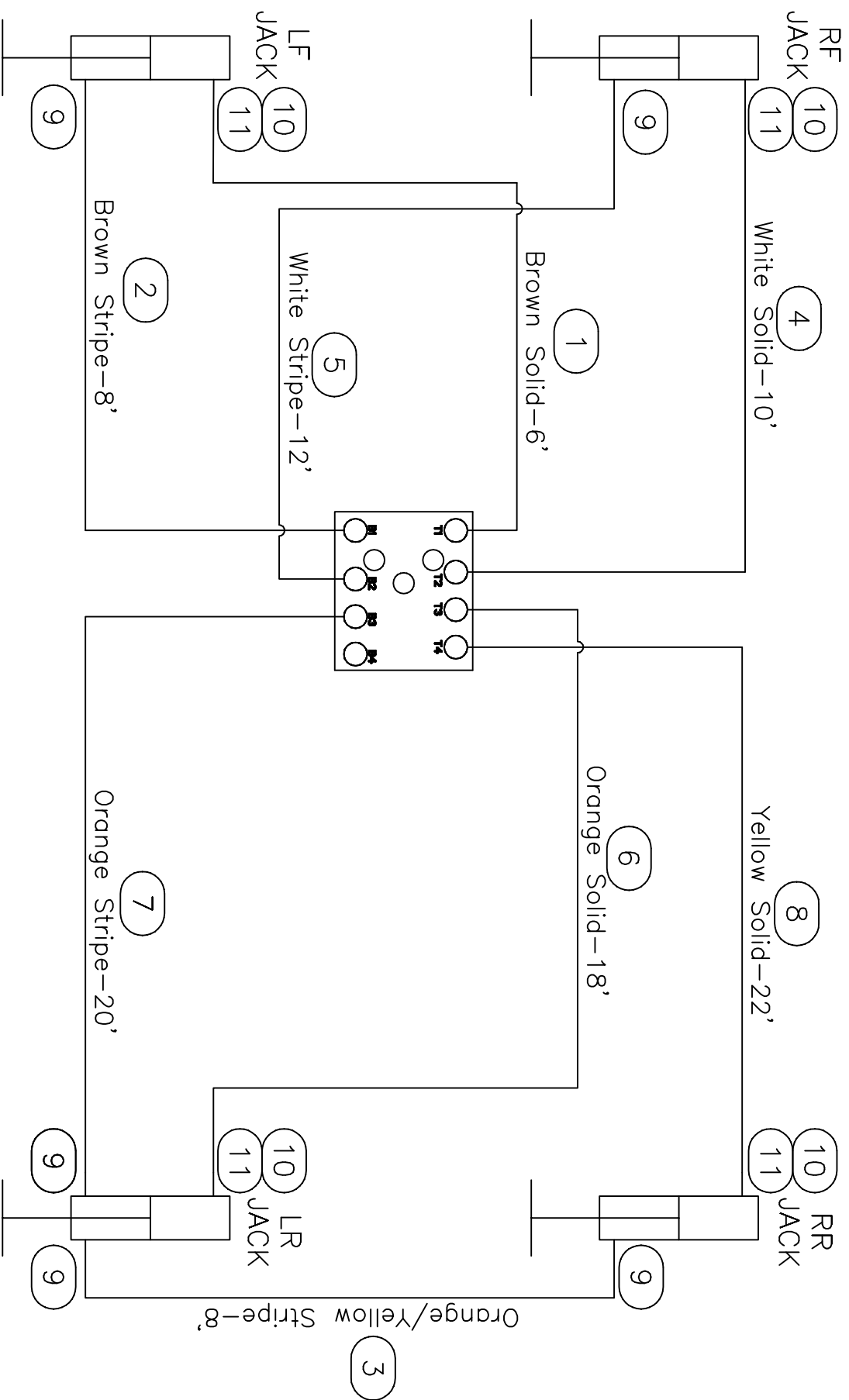

Warranty authorization must come directly from Equalizer Systems. (800) 846-9659.

<i>Equalizer</i>		55169 COUNTY ROAD 3 ELKHART, IN 46515		#		REVISIONS		BY:		DATE:		UNLESS OTHERWISE SPECIFIED:		TITLE		USED ON:	
												TOLERANCES:		NEXUS HOSE CHART		GHOST, WRAITH	
												.XXX ± 0.010		A			
												.XX ± 0.010		N/A			
												.X ± 0.030		A			
												ANG. ± 1/2"		DATE:		NOTED	
												REMOVE ALL BURRS AND SHARP EDGES .015 MAX		AP'D BY		DATE:	
														SU		6/15/18	
														DATE:		PART NAME:	
														PAGE:		HOSE KIT-NEXUS 8439	
														2 OF 2		DWG NO.: P70129	
																REV:	

NOTICE - This drawing, including principles of design, is the property of Dye Corporation, Elkhart, Indiana, with the agreement that it is not to be reproduced, copied, or loaned in any manner that may constitute a detriment directly or indirectly to Dye Corporation. Acceptance of this will be construed as an agreement of the above.

70139 PARTS LIST

ITEM	PART #	DESCRIPTION	QUAN	COLOR CODE	LOCATION
1	2465	HOSE-10'	1	ORANGE STRIPE/YELLOW STRIPE	BOTTOM OF LR JACK TO BOTTOM OF RR JACK
2	2463	HOSE-8'	1	BROWN STRIPE/WHITE STRIPE	BOTTOM OF LF JACK TO BOTTOM OF RF JACK
3	2469	HOSE-14'	1	BROWN SOLID	PUMP PORT T1 TO TOP OF LF JACK
4	2469	HOSE-14'	1	BROWN STRIPE	PUMP PORT B1 TO BOTTOM OF LF JACK
5	2488	HOSE-38'	1	ORANGE SOLID	PUMP PORT T3 TO TOP OF LR JACK
6	2488	HOSE-38'	1	ORANGE STRIPE	PUMP PORT B3 TO BOTTOM OF LR JACK
7	2473	HOSE-18'	1	WHITE SOLID	PUMP PORT T2 TO TOP OF RF JACK
8	2490	HOSE-40'	1	YELLOW SOLID	PUMP PORT T4 TO TOP OF RR JACK

REQUIRED JACK FITTINGS

ITEM	PART #	DESCRIPTION	QUAN
9	1124	FITTING-#4 JIC X #4 OR MALE 90	6
10	1190	FITTING-#4 X #4 JIC SWIVEL 90	4
11	1403	FITTING-RESTRICTOR #6 X #4-042 ORIFICE	4

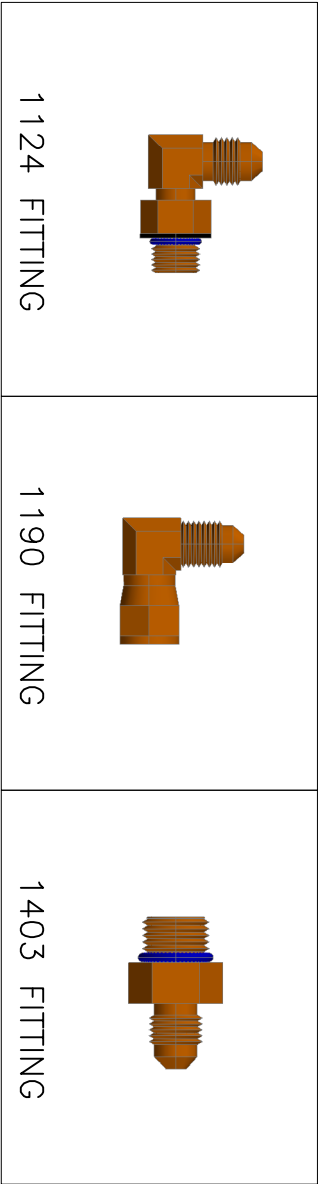

Warranty authorization must come directly from Equalizer Systems. (800) 846-9659.

Equalizer 55169 COUNTRY ROAD 3 ELKHART, IN 46515	#	REVISIONS	BY:	DATE:	UNLESS OTHERWISE SPECIFIED: TOLERANCES: .XXX ± 0.010 .XX ± 0.010 .X ± 0.020 ANG. ± 1/2" REMOVE ALL BURRS AND SHARP EDGES .015 MAX	TITLE NEXUS HOSE CHART	USED ON: BENTLEY
NOTICE - This drawing, including principles of design, is the property of Doye Corporation, Elkhart, Indiana, with the agreement that it is not to be reproduced, copied, or loaned in any manner that may constitute a detriment directly or indirectly to Doye Corporation. Acceptance of this will be construed as an agreement of the above.						SIZE SCALE MATERIAL A 1:1 A S	NOTE PART NAME: HOSE KIT-NEXUS 8726 PAGE: 1 OF 2 DWG NO.: P70139 REV: -

PUMP TO CONTROL PANEL HARNESS #6133-10

BY:	DATE:	UNLESS OTHERWISE SPECIFIED:	TITLE	USED ON:
		TOLERANCES:	MH 15 SL LEG ASSEMBLY	NEXUS
		.XXX ± 0.010	SIZE SCALE	MATERIAL
		.XX ± 0.010	A 1:1	AS NOTED
		X ± 0.030	DRW BY: DATE:	PART NAME:
		ANG. ± 1/2°	SCHASS/59/INTERFAC	16 CONNECTIONS
		REMOVE ALL BURRS AND SHARP EDGES .015 MAX	APP'D BY DATE:	PAGE: 3 OF 3
			DWG NO.: 763969	REV:

BI-ROTATIONAL PUMP #7948KS

INPUT. IGNITION FROM COACH. 12V+ WHEN IGN ON. 18 PINK

BI-ROTATIONAL PUMP #7948KS

HARNESS 6910

PIN	PAGE	COLOR	INPUT. 12V+ TO LEFT REAR VALVE COIL
1	18	ORANGE	INPUT. 12V+ TO RIGHT FRONT VALVE COIL
2	18	WHITE	INPUT. 12V+ TO MOTOR EXTEND SOLENOID
3	16	DARK BLUE	INPUT. 12V+ TO RIGHT REAR VALVE COIL
4	18	YELLOW	INPUT. 12V+ TO LEFT FRONT VALVE COIL
5	18	BROWN	INPUT. 12V+ TO MOTOR RETRACT SOLENOID
6	16	DARK GREEN	
7			
8			
9	18	YELLOW/BLACK	PRESSURE SW 12V+ OUTPUT

HARNESS 6572C

PIN	PAGE	COLOR	GROUND FROM CHASSIS
B	16	BLACK	12V+ YELLOW (20A FUSE)
A	12	RED	

EQUALIZER SYSTEMS
MAIN 12V POWER
INPUT. FROM PUMP
MOTOR SOLENOID
AND CHASSIS
BATTERIES.

NOTES:

THE 12V POWER SOURCE MUST NOT DROP BELOW 10.5 VOLTS MEASURED AT THE YELLOW FUSE WIRE ON THE PUMP OR THE PUMP VALVE COIL BEING ENERGIZED WITH THE METER GROUND ON THE PUMP CASE GROUND.

THE PARK BRAKE INPUT TO THE LEVEL CONTROLLER ARE GROUND INPUTS. IT IS PULLED HIGH TO 12V INTERNALLY THROUGH A RESISTOR. IT IS LOOKING FOR AN ACTIVE LOW INPUT SIGNAL. WHEN THE PARK BRAKE IS ON, IT'S SENDING A GROUND TO THE PARK BRAKE INPUT OF THE LEVEL CONTROLLER.

GROUND INPUT
FROM CHASSIS
CONNECTED TO STUD
ON SIDE OF PUMP

Note:
On each pair of jacks in this system, one jack will have (1) 1124 fitting and the other will

haves (2) 1124 fittings

ELKHART, IN 46515

Equalizer

UNLESS OTHERWISE SPECIFIED:

TITLE

SIZE SCALE

MATERIAL

NOTED

DRW BY: DATE:

SCHASS/59/INTERFAC

PART NAME:

16 CONNECTIONS

REMOVE ALL BURRS AND SHARP EDGES .015 MAX

APP'D BY DATE:

PAGE: 3 OF 3

DWG NO.: 763969

REV:

UNLESS OTHERWISE SPECIFIED:

TITLE

SIZE SCALE

MATERIAL

NOTED

DRW BY: DATE:

SCHASS/59/INTERFAC

PART NAME:

16 CONNECTIONS

REMOVE ALL BURRS AND SHARP EDGES .015 MAX

APP'D BY DATE:

PAGE: 3 OF 3

DWG NO.: 763969

REV:

UNLESS OTHERWISE SPECIFIED:

TITLE

SIZE SCALE

MATERIAL

NOTED

DRW BY: DATE:

SCHASS/59/INTERFAC

PART NAME:

16 CONNECTIONS

REMOVE ALL BURRS AND SHARP EDGES .015 MAX

APP'D BY DATE:

PAGE: 3 OF 3

DWG NO.: 763969

REV:

UNLESS OTHERWISE SPECIFIED:

TITLE

SIZE SCALE

MATERIAL

NOTED

DRW BY: DATE:

SCHASS/59/INTERFAC

PART NAME:

16 CONNECTIONS

REMOVE ALL BURRS AND SHARP EDGES .015 MAX

APP'D BY DATE:

PAGE: 3 OF 3

DWG NO.: 763969

REV:

UNLESS OTHERWISE SPECIFIED:

TITLE

SIZE SCALE

MATERIAL

NOTED

DRW BY: DATE:

SCHASS/59/INTERFAC

PART NAME:

16 CONNECTIONS

REMOVE ALL BURRS AND SHARP EDGES .015 MAX

APP'D BY DATE:

PAGE: 3 OF 3

DWG NO.: 763969

REV:

UNLESS OTHERWISE SPECIFIED:

TITLE

SIZE SCALE

MATERIAL

NOTED

DRW BY: DATE:

SCHASS/59/INTERFAC

PART NAME:

16 CONNECTIONS

REMOVE ALL BURRS AND SHARP EDGES .015 MAX

APP'D BY DATE:

PAGE: 3 OF 3

DWG NO.: 763969

REV:

UNLESS OTHERWISE SPECIFIED:

TITLE

SIZE SCALE

MATERIAL

NOTED

DRW BY: DATE:

SCHASS/59/INTERFAC

PART NAME:

16 CONNECTIONS

REMOVE ALL BURRS AND SHARP EDGES .015 MAX

APP'D BY DATE:

PAGE: 3 OF 3

DWG NO.: 763969

REV:

UNLESS OTHERWISE SPECIFIED:

TITLE

SIZE SCALE

MATERIAL

NOTED

DRW BY: DATE:

SCHASS/59/INTERFAC

PART NAME:

16 CONNECTIONS

REMOVE ALL BURRS AND SHARP EDGES .015 MAX

APP'D BY DATE:

PAGE: 3 OF 3

DWG NO.: 763969

REV:

UNLESS OTHERWISE SPECIFIED:

TITLE

SIZE SCALE

MATERIAL

NOTED

DRW BY: DATE:

SCHASS/59/INTERFAC

PART NAME:

16 CONNECTIONS

REMOVE ALL BURRS AND SHARP EDGES .015 MAX

APP'D BY DATE:

PAGE: 3 OF 3

DWG NO.: 763969

REV:

UNLESS OTHERWISE SPECIFIED:

TITLE

SIZE SCALE

MATERIAL

NOTED

DRW BY: DATE:

SCHASS/59/INTERFAC

PART NAME:

16 CONNECTIONS

REMOVE ALL BURRS AND SHARP EDGES .015 MAX

APP'D BY DATE:

PAGE: 3 OF 3

DWG NO.: 763969

REV:

UNLESS OTHERWISE SPECIFIED:

TITLE

SIZE SCALE

MATERIAL

NOTED

DRW BY: DATE:

SCHASS/59/INTERFAC

PART NAME:

16 CONNECTIONS

REMOVE ALL BURRS AND SHARP EDGES .015 MAX

APP'D BY DATE:

PAGE: 3 OF 3

DWG NO.: 763969

REV:

UNLESS OTHERWISE SPECIFIED:

TITLE

SIZE SCALE

MATERIAL

NOTED

DRW BY: DATE:

SCHASS/59/INTERFAC

PART NAME:

16 CONNECTIONS

REMOVE ALL BURRS AND SHARP EDGES .015 MAX

APP'D BY DATE:

PAGE: 3 OF 3

DWG NO.: 763969

REV:

UNLESS OTHERWISE SPECIFIED:

TITLE

SIZE SCALE

MATERIAL

NOTED

DRW BY: DATE:

SCHASS/59/INTERFAC

PART NAME:

16 CONNECTIONS

REMOVE ALL BURRS AND SHARP EDGES .015 MAX

APP'D BY DATE:

PAGE: 3 OF 3

DWG NO.: 763969

REV:

UNLESS OTHERWISE SPECIFIED:

TITLE

SIZE SCALE

MATERIAL

NOTED

DRW BY: DATE:

SCHASS/59/INTERFAC

PART NAME:

16 CONNECTIONS

REMOVE ALL BURRS AND SHARP EDGES .015 MAX

APP'D BY DATE:

PAGE: 3 OF 3

DWG NO.: 763969

REV:

UNLESS OTHERWISE SPECIFIED:

TITLE

SIZE SCALE

MATERIAL

NOTED

DRW BY: DATE:

SCHASS/59/INTERFAC

PART NAME:

16 CONNECTIONS

REMOVE ALL BURRS AND SHARP EDGES .015 MAX

APP'D BY DATE:

PAGE: 3 OF 3

DWG NO.: 763969

REV:

UNLESS OTHERWISE SPECIFIED:

TITLE

SIZE SCALE

MATERIAL

NOTED

DRW BY: DATE:

SCHASS/59/INTERFAC

PART NAME:

16 CONNECTIONS

REMOVE ALL BURRS AND SHARP EDGES .015 MAX

APP'D BY DATE:

PAGE: 3 OF 3

DWG NO.: 763969

REV:

UNLESS OTHERWISE SPECIFIED:

TITLE

SIZE SCALE

MATERIAL

NOTED

DRW BY: DATE:

SCHASS/59/INTERFAC

PART NAME:

16 CONNECTIONS

REMOVE ALL BURRS AND SHARP EDGES .015 MAX

APP'D BY DATE:

PAGE: 3 OF 3

DWG NO.: 763969

REV:

UNLESS OTHERWISE SPECIFIED:

TITLE

SIZE SCALE

MATERIAL

NOTED

DRW BY: DATE:

SCHASS/59/INTERFAC

PART NAME:

16 CONNECTIONS

REMOVE ALL BURRS AND SHARP EDGES .015 MAX

APP'D BY DATE:

PAGE: 3 OF 3

DWG NO.: 763969

REV:

UNLESS OTHERWISE SPECIFIED:

TITLE

SIZE SCALE

MATERIAL

NOTED

DRW BY: DATE:

SCHASS/59/INTERFAC

PART NAME:

16 CONNECTIONS

REMOVE ALL BURRS AND SHARP EDGES .015 MAX

APP'D BY DATE:

PAGE: 3 OF 3

DWG NO.: 763969

REV:

UNLESS OTHERWISE SPECIFIED:

TITLE

SIZE SCALE

MATERIAL

NOTED

DRW BY: DATE:

SCHASS/59/INTERFAC

PART NAME:

16 CONNECTIONS

REMOVE ALL BURRS AND SHARP EDGES .015 MAX

APP'D BY DATE:

PAGE: 3 OF 3

DWG NO.: 763969

REV:

UNLESS OTHERWISE SPECIFIED:

TITLE

PUMP TO CONTROL PANEL HARNESS #6133-20

CHASSIS INTERFACE CONNECTIONS

INPUT. IGNITION FROM COACH. 12V+ WHEN IGN ON.

PAGE	COLOR
18	PINK

INPUT. PARK BRAKE GND WHEN BRAKE ON

18	BLACK/YELLOW
----	--------------

BI-ROTATIONAL PUMP #7948KS

HARNESS 6910

PIN	PAGE	COLOR
1	18	ORANGE
2	18	WHITE
3	18	BLUE
4	18	YELLOW
5	18	BROWN
6	18	GREEN
7		
8		
9	18	YELLOW/BLACK

PIN	PAGE	COLOR
1	18	ORANGE
2	18	WHITE
3	16	DARK BLUE
4	18	YELLOW
5	18	BROWN
6	16	DARK GREEN
7		
8		
9	18	YELLOW/BLACK

INPUT. 12V+ TO LEFT REAR VALVE COIL
INPUT. 12V+ TO RIGHT FRONT VALVE COIL
INPUT. 12V+ TO MOTOR EXTEND SOLENOID
INPUT. 12V+ TO RIGHT REAR VALVE COIL
INPUT. 12V+ TO LEFT FRONT VALVE COIL
INPUT. 12V+ TO MOTOR RETRACT SOLENOID
PRESSURE SW 12V+ OUTPUT

SMART LEVEL CONTROL PANEL #3197SRT

INPUT 12V+ FROM PUMP (MINIMUM 10.5V)
INPUT 12V+ FROM PUMP (MINIMUM 10.5V)
INPUT GND FROM PUMP

PIN	PAGE	COLOR
1	16	RED
2	16	RED
3	16	BLACK

INPUT. PARK BRAKE GND. SEE NOTES
INPUT. 12V+ WHEN IGN ON

PIN	PAGE	COLOR
1		
2	18	BLACK/YELLOW
3	18	PINK
4	18	YELLOW/BLACK
5		
6	18	GREEN
7		
8	18	YELLOW
9	18	ORANGE
10	18	WHITE
11	18	BROWN
12	18	BLUE

OUTPUT 12V+ TO PUMP RETRACT
OUTPUT 12V+ TO PUMP VALVE RR
OUTPUT 12V+ TO PUMP VALVE LR
OUTPUT 12V+ TO PUMP VALVE RF
OUTPUT 12V+ TO PUMP VALVE LF
OUTPUT 12V+ TO PUMP EXTEND

PIN	PAGE	COLOR
1		
2	18	BLACK/YELLOW
3	18	PINK
4	18	YELLOW/BLACK
5		
6	18	GREEN
7		
8	18	YELLOW
9	18	ORANGE
10	18	WHITE
11	18	BROWN
12	18	BLUE

HARNESS 6572C

PIN	PAGE	COLOR
B	16	BLACK
A	12	RED

PIN	PAGE	COLOR
B	12	BLACK
A	12	RED

GROUND FROM CHASSIS
12V+ YELLOW (20A FUSE)

EQUALIZER SYSTEMS
MAIN 12V POWER
INPUT. FROM PUMP
MOTOR SOLENOID
AND CHASSIS
BATTERIES.

GROUND INPUT
FROM CHASSIS
CONNECTED TO STUD
ON SIDE OF PUMP

NOTES:

THE 12V POWER SOURCE MUST NOT DROP BELOW 10.5 VOLTS MEASURED AT THE YELLOW FUSE WIRE ON THE PUMP OR THE PUMP VALVE COIL BEING ENERGIZED WITH THE METER GROUND ON THE PUMP CASE GROUND.

THE PARK BRAKE INPUT TO THE LEVEL CONTROLLER ARE GROUND INPUTS. IT IS PULLED HIGH TO 12V INTERNALLY THROUGH A RESISTOR. IT IS LOOKING FOR AN ACTIVE LOW INPUT SIGNAL. WHEN THE PARK BRAKE IS ON, IT'S SENDING A GROUND TO THE PARK BRAKE INPUT OF THE LEVEL CONTROLLER.

Equalizer

55169 COUNTRY ROAD 3
ELKHART, IN 46515

REVISIONS

BY: DATE:

UNLESS OTHERWISE SPECIFIED:
TOLERANCES:
.XXX ± 0.010
.XX ± 0.010
.X ± 0.030
ANG. ± 1/2°

TITLE
AUTO LEVEL SCHEMATIC

USED ON:
MAYBACH

SIZE SCALE MATERIAL

PART NAME:

DRW BY: DATE: 3/2/15

AUTO LEVEL WIRING SCHEMATIC

NOTICE – This drawing, including principles of design, is the property of Days Corporation, Elkhart, Indiana, with the agreement that it is not to be reproduced, copied, or loaned in any manner that may constitute a detriment directly or indirectly to Days Corporation. Acceptance of this will be construed as an agreement of the above.

#

REVISIONS

BY: DATE:

UNLESS OTHERWISE SPECIFIED:
TOLERANCES:
.XXX ± 0.010
.XX ± 0.010
.X ± 0.030
ANG. ± 1/2°

TITLE
AUTO LEVEL SCHEMATIC

USED ON:
MAYBACH

SIZE SCALE MATERIAL
DRW BY: DATE: 3/2/15
PART NAME:
AUTO LEVEL WIRING SCHEMATIC
PAGE: 1 OF 1
DWG NO.: P8438
REV: —

PUMP TO CONTROL PANEL HARNESS #6133-20

CHASSIS INTERFACE CONNECTIONS

INPUT. IGNITION FROM COACH. 12V+ WHEN IGN ON.

PAGE	COLOR
18	PINK

INPUT. PARK BRAKE GND WHEN BRAKE ON

18	BLACK/YELLOW
----	--------------

BI-ROTATIONAL PUMP #70127KS

HARNESS 6910

PIN/GAGE	COLOR
1 18	ORANGE
2 18	WHITE
3 18	BLUE
4 18	YELLOW
5 18	BROWN
6 18	GREEN
7	
8	
9 18	YELLOW/BLACK

PIN/GAGE	COLOR
1 18	ORANGE
2 18	WHITE
3 16	DARK BLUE
4 18	YELLOW
5 18	BROWN
6 16	DARK GREEN
7	
8	
9 18	YELLOW/BLACK

INPUT. 12V+ TO LEFT REAR VALVE COIL
INPUT. 12V+ TO RIGHT FRONT VALVE COIL
INPUT. 12V+ TO MOTOR EXTEND SOLENOID
INPUT. 12V+ TO RIGHT REAR VALVE COIL
INPUT. 12V+ TO LEFT FRONT VALVE COIL
INPUT. 12V+ TO MOTOR RETRACT SOLENOID

PRESSURE SW 12V+ OUTPUT

HARNESS 6572C

SMART LEVEL CONTROL PANEL #3197SRT

INPUT 12V+ FROM PUMP (MINIMUM 10.5V)
INPUT 12V+ FROM PUMP (MINIMUM 10.5V)
INPUT GND FROM PUMP

PIN/GAGE	COLOR
1 16	RED
2 16	RED
3 16	BLACK

INPUT. PARK BRAKE GND. SEE NOTES
INPUT. 12V+ WHEN IGN ON

PIN/GAGE	COLOR
1	
2 18	BLACK/YELLOW
3 18	PINK
4 18	YELLOW/BLACK
5	
6 18	GREEN
7	
8 18	YELLOW
9 18	ORANGE
10 18	WHITE
11 18	BROWN
12 18	BLUE

OUTPUT 12V+ TO PUMP RETRACT
OUTPUT 12V+ TO PUMP VALVE RR
OUTPUT 12V+ TO PUMP VALVE LR
OUTPUT 12V+ TO PUMP VALVE RF
OUTPUT 12V+ TO PUMP VALVE LF
OUTPUT 12V+ TO PUMP EXTEND

PIN/GAGE	COLOR
1	
2 18	BLACK/YELLOW
3 18	PINK
4 18	YELLOW/BLACK
5	
6 18	GREEN
7	
8 18	YELLOW
9 18	ORANGE
10 18	WHITE
11 18	BROWN
12 18	BLUE

EQUALIZER SYSTEMS
MAIN 12V POWER
INPUT. FROM PUMP
MOTOR SOLENOID
AND CHASSIS
BATTERIES.

GROUND INPUT
FROM CHASSIS
CONNECTED TO STUD
ON SIDE OF PUMP

NOTES:

THE 12V POWER SOURCE MUST NOT DROP BELOW 10.5 VOLTS MEASURED AT THE YELLOW FUSE WIRE ON THE PUMP OR THE PUMP VALVE COIL BEING ENERGIZED WITH THE METER GROUND ON THE PUMP CASE GROUND.

THE PARK BRAKE INPUT TO THE LEVEL CONTROLLER ARE GROUND INPUTS. IT IS PULLED HIGH TO 12V INTERNALLY THROUGH A RESISTOR. IT IS LOOKING FOR AN ACTIVE LOW INPUT SIGNAL. WHEN THE PARK BRAKE IS ON, IT'S SENDING A GROUND TO THE PARK BRAKE INPUT OF THE LEVEL CONTROLLER.

Equalizer

55169 COUNTRY ROAD 3
ELKHART, IN 46515

REVISIONS

BY: DATE:

UNLESS OTHERWISE SPECIFIED:
TOLERANCES:
.XXX ± 0.010
.XX ± 0.010
.X ± 0.030
ANG. ± 1/2°

TITLE
AUTO LEVEL SCHEMATIC

USED ON:
GHOST, WRAITH

NOTICE – This drawing, including principles of design, is the property of Days Corporation, Elkhart, Indiana, with the agreement that it is not to be reproduced, copied, or loaned in any manner that may constitute a detriment directly or indirectly to Days Corporation. Acceptance of this will be construed as an agreement of the above.

#	REVISIONS	BY:	DATE:	UNLESS OTHERWISE SPECIFIED: TOLERANCES: .XXX ± 0.010 .XX ± 0.010 .X ± 0.030 ANG. ± 1/2° REMOVE ALL BURRS AND SHARP EDGES .015 MAX	TITLE AUTO LEVEL SCHEMATIC	USED ON: GHOST, WRAITH
					SIZE SCALE MATERIAL	
					DRW BY: DATE: 3/2/15	PART NAME: AUTO LEVEL WIRING SCHEMATIC
					APP'D BY DATE:	PAGE: 1 OF 1 DWG NO.: P8439 REV: —